

IZA BAHSSI
CÉLIA BRAHMI
JOE MEDINA-RODRIGUEZ
NINA PIZZI
SHADI PLOYE

PROJET
PIXEL

CERDA'S BLOCK

Light coming from a central patio
Full, never-changing building line

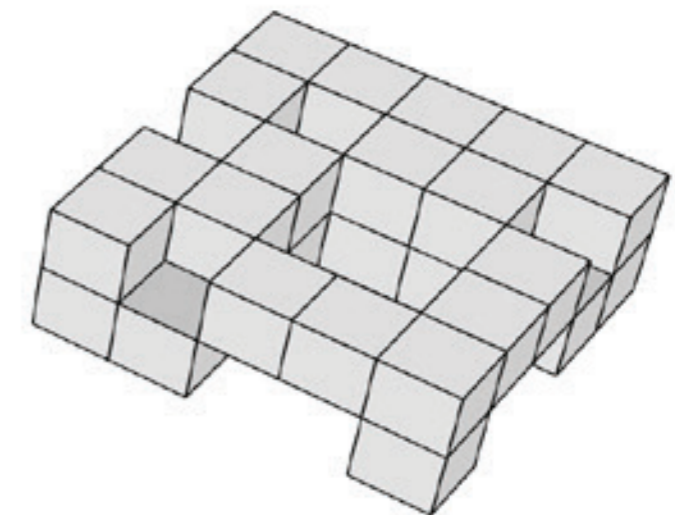
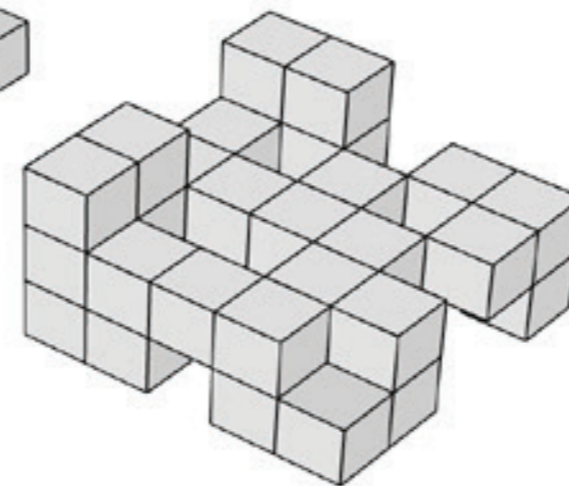
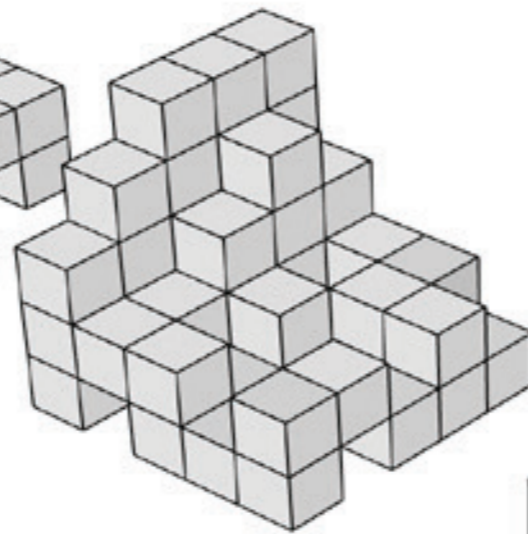
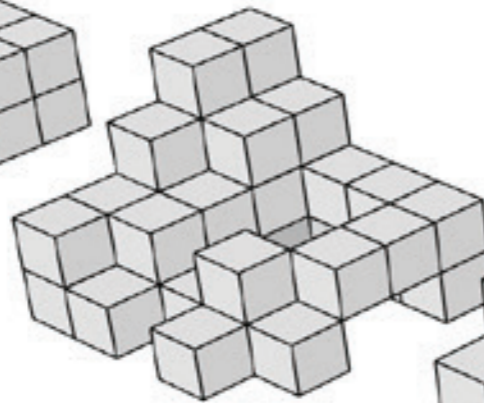
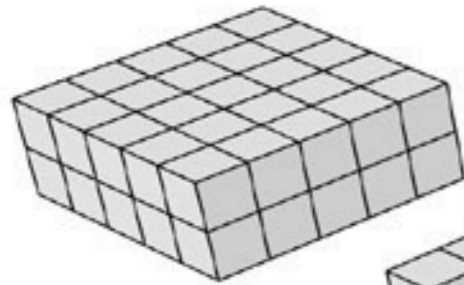
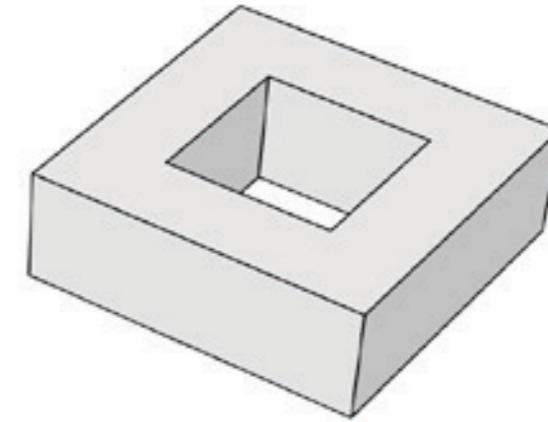
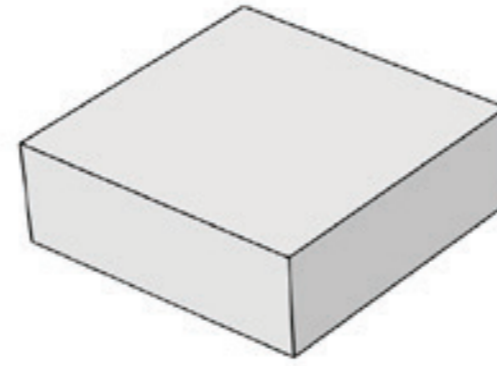

NEW BLOCKS

Light coming from multiple patios
Flexible, adaptable and dynamic

LE CONTEXTE



UN SITE AU MILIEU DE DEUX PORTES DE PARIS

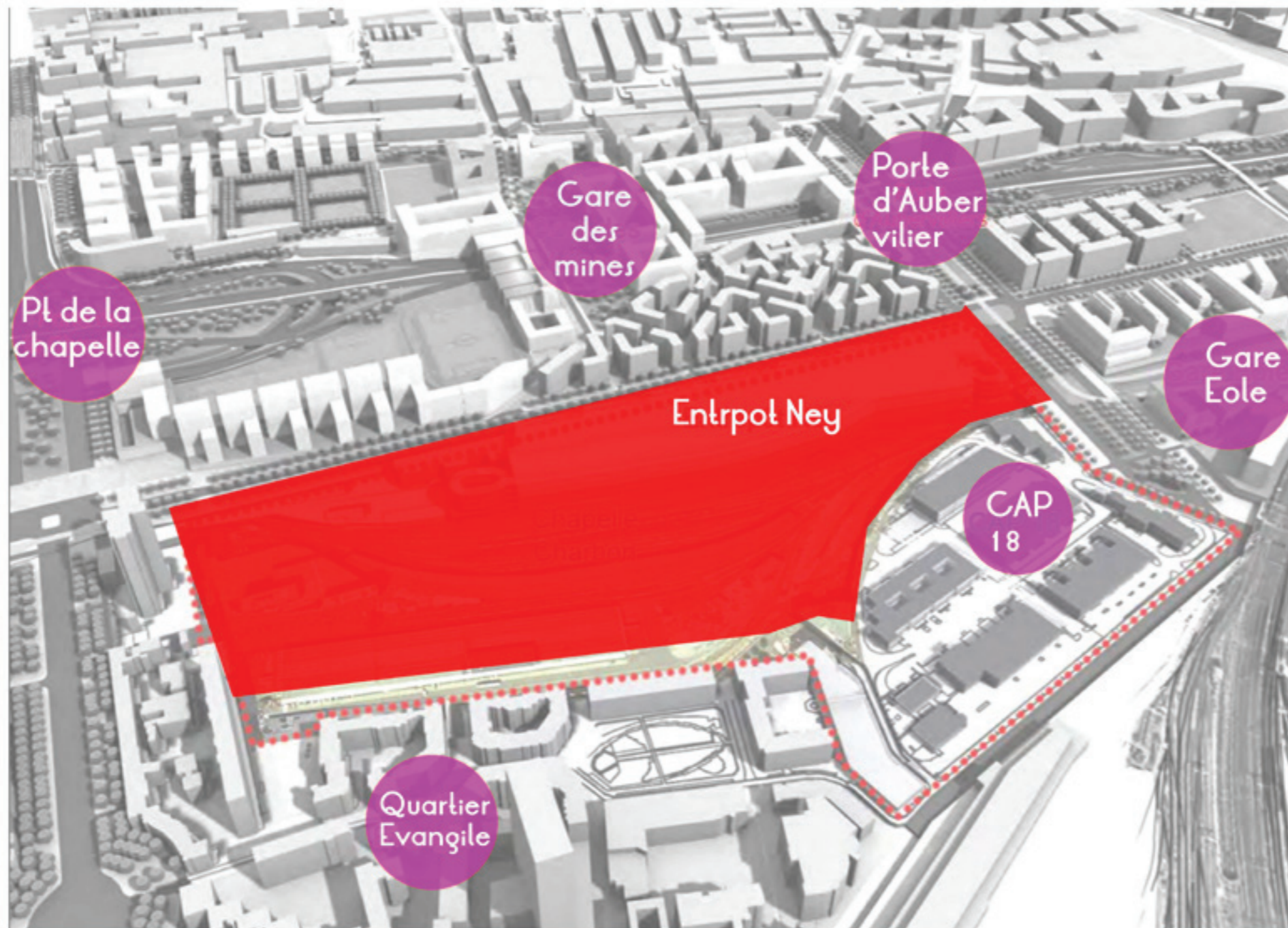

INTENTIONS DU PROJET

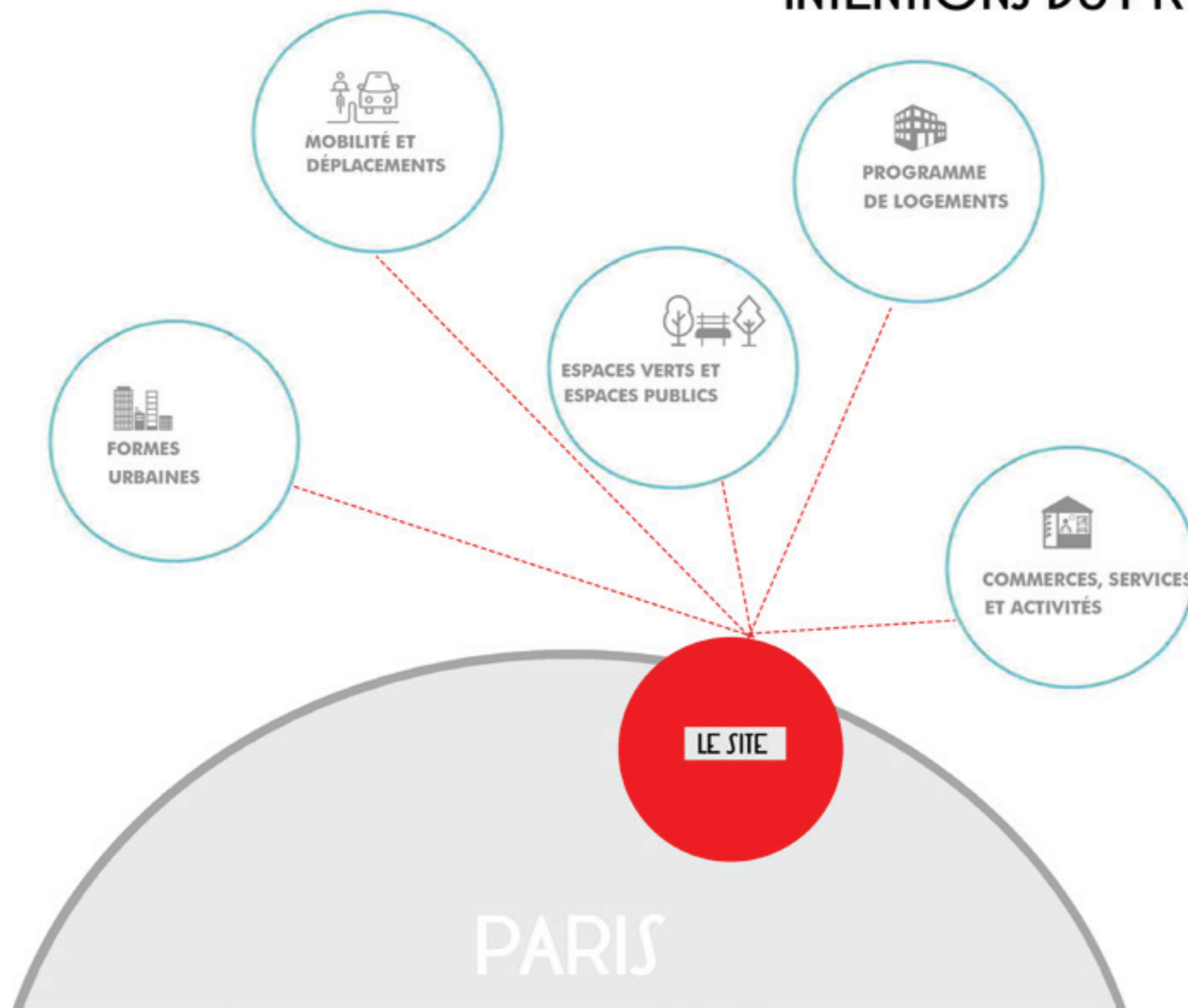

Un programme mixte pour redynamiser le quartier

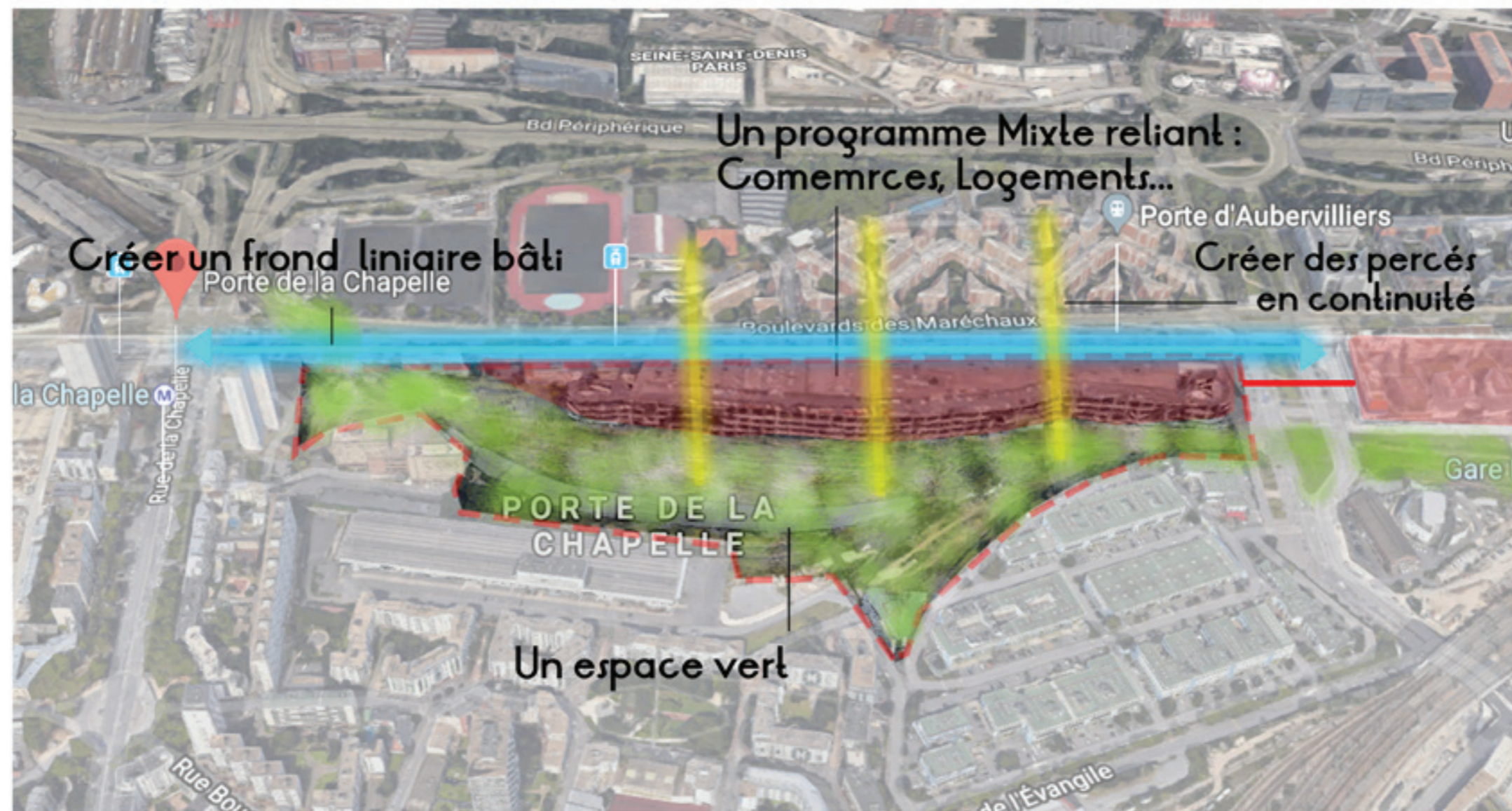

Un projet qui s'intègre dans l'environnement
tout en étant dense

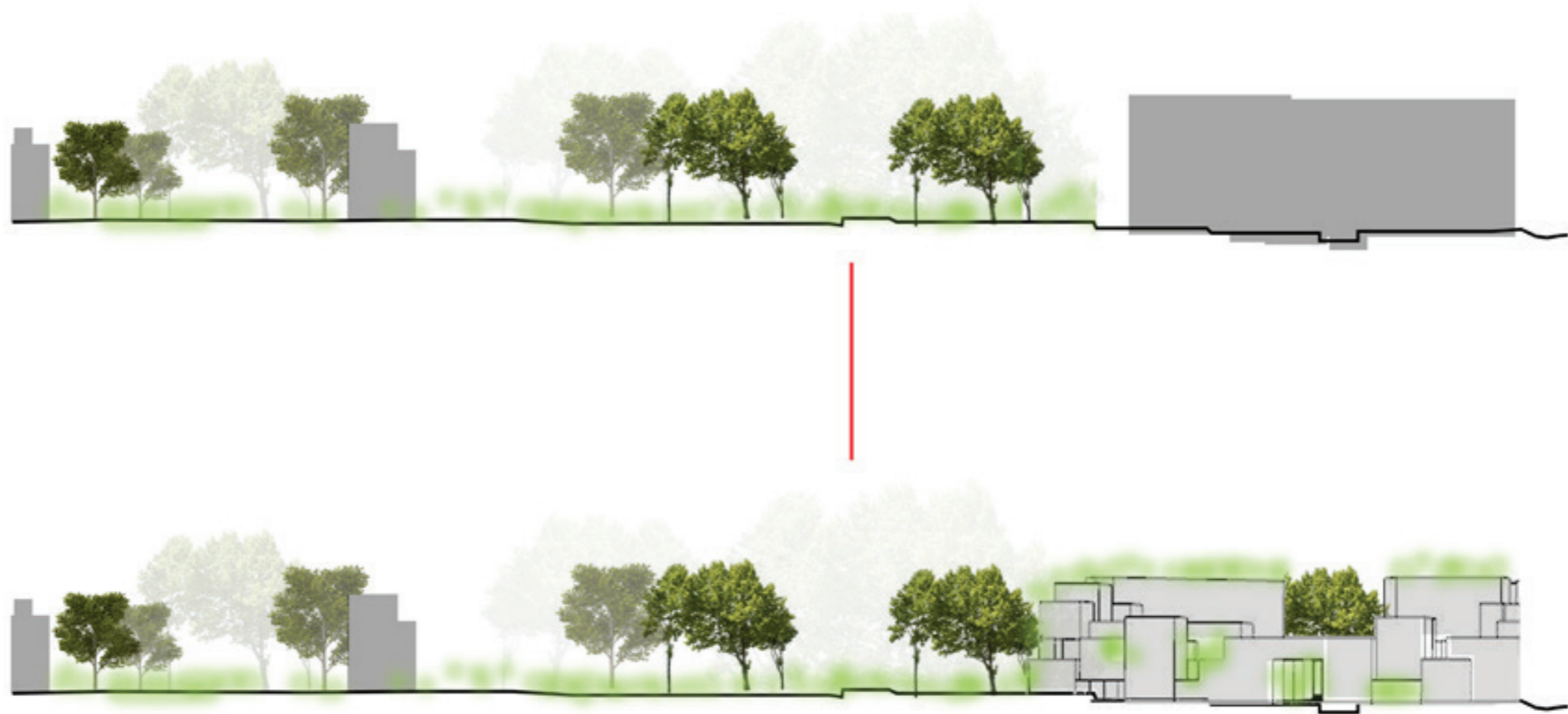

LES ENTREPÔTS MACDONALD - PARIS 19

Construction d'un îlot à la place des anciens entrepôts logistiques
Livraison : 2013

Architecte Coordinateur
Floris Alkemade et Xavier de Geyter Architecten
(Masterplan par OMA (Rem Koolhaas))
Michel Desvignes, paysagiste
Maîtrise d'ouvrage - SAS ParisNordEST (Caisse des Dépôts, Icade, Semavip)
Aménageur - SEMAVIP

Programme
Surface globale : 165 000 m² (610 m façade totale)
Logements : 71 300 m²
Bureaux : 28 000 m²
Commerces : 32 500 m²
Activités : 16 000 m²
Equipements publics (école, collège, crèche, gymnase) : 17 000 m²

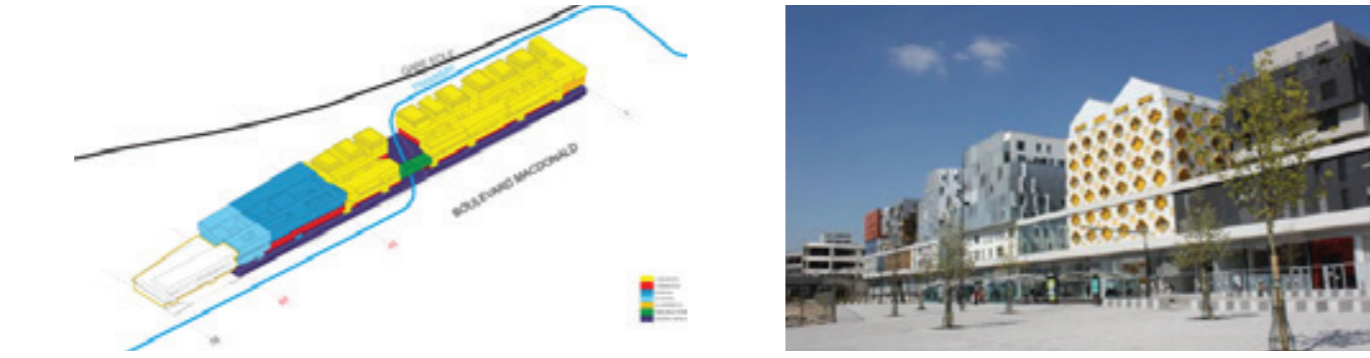

Plan du rez-de-chaussée

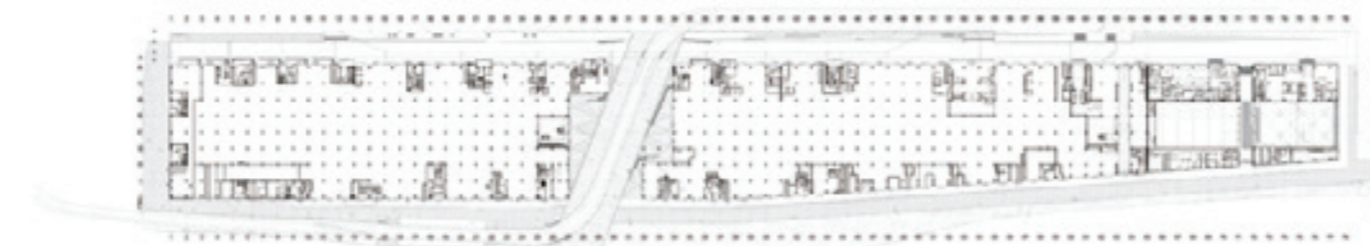

Plan du quatrième étage

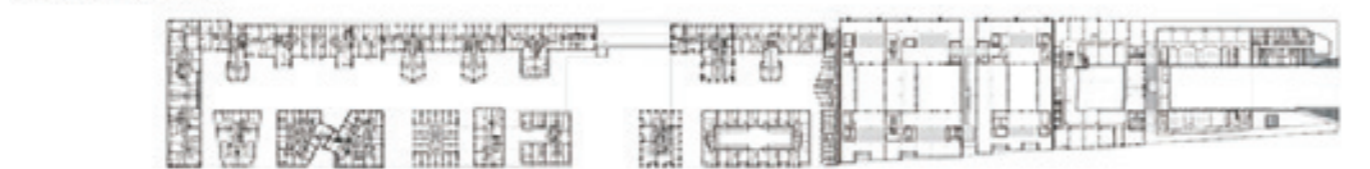

Référence : Habitat 67 au Havre





Plan masse
Echelle : 1/1000^{ème}

PROGRAMMES ET MATÉRIAUX

- EQUIPEMENTS CULTURELS
- EQUIPEMENTS FAMILIAUX
- PETITS COMMERCES
- COMMERCES MOYENS
- LOGEMENTS
- BUREAUX

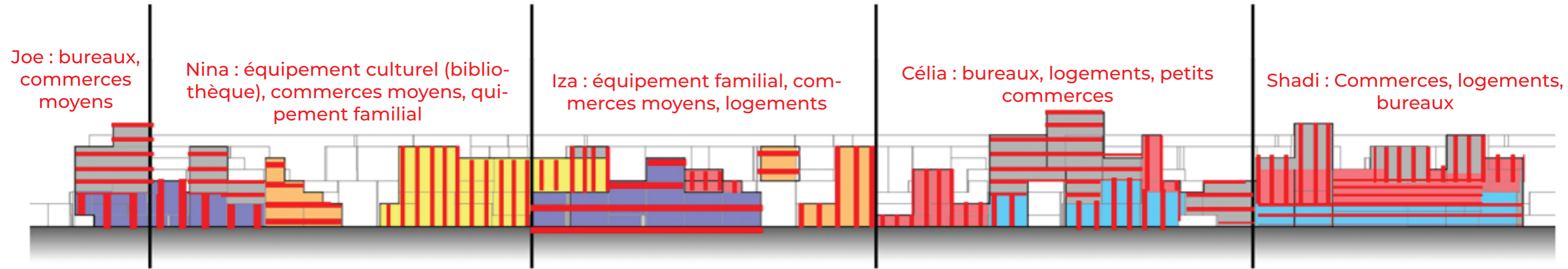

CIRCULATION DANS LA PARCELLE

