

2 BIOGRAPHIE
LA GRILLE: VARIATIONS DE STRUCTURE ET ESPACES INTÉRIEURS PRODUITS,
DE REM KOOLHAAS À TOYO ITO.

ARCHITECTURE, LAB CITY, REM KOOLHAAS

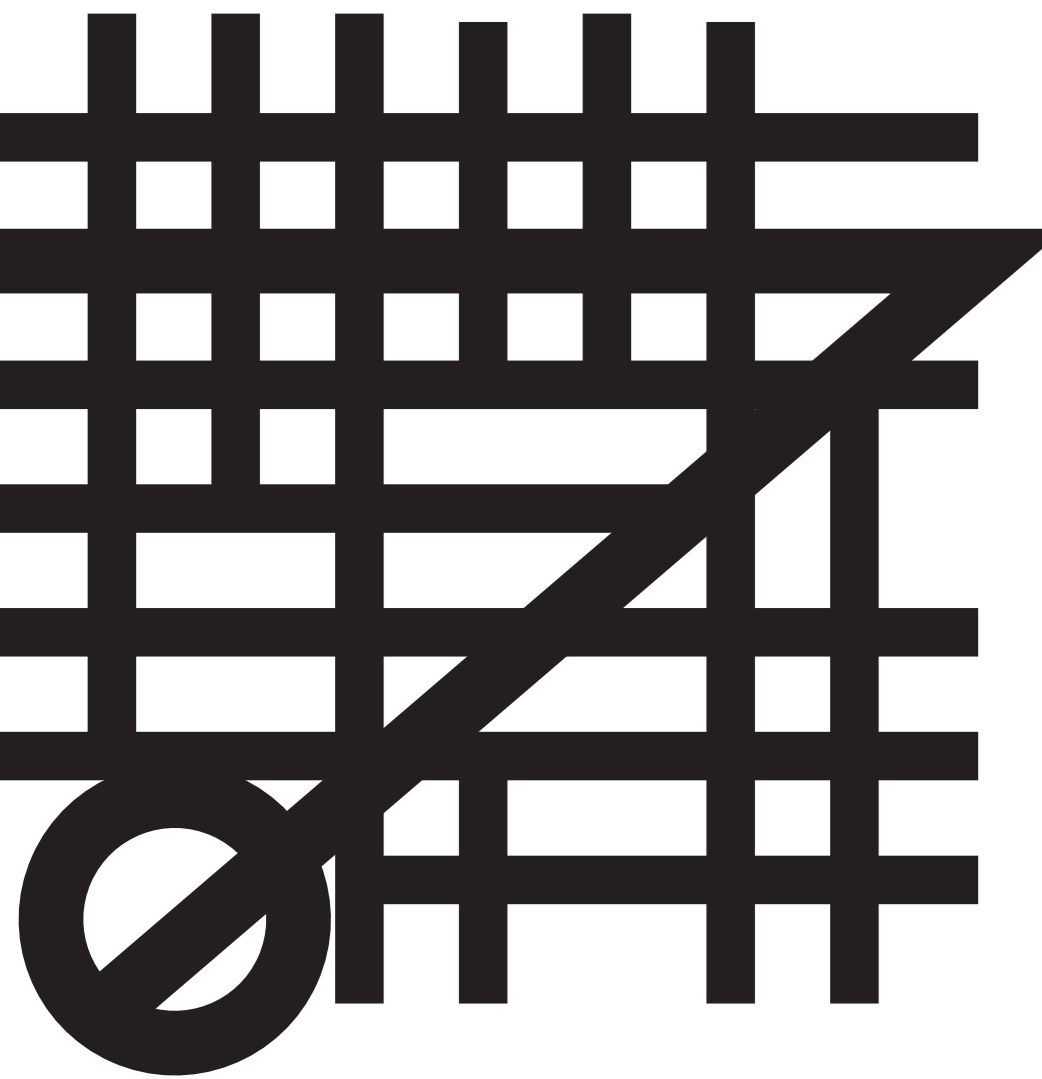

ARCHITECTURE, CONCEPT, CHRISTIAN KEREZ 1

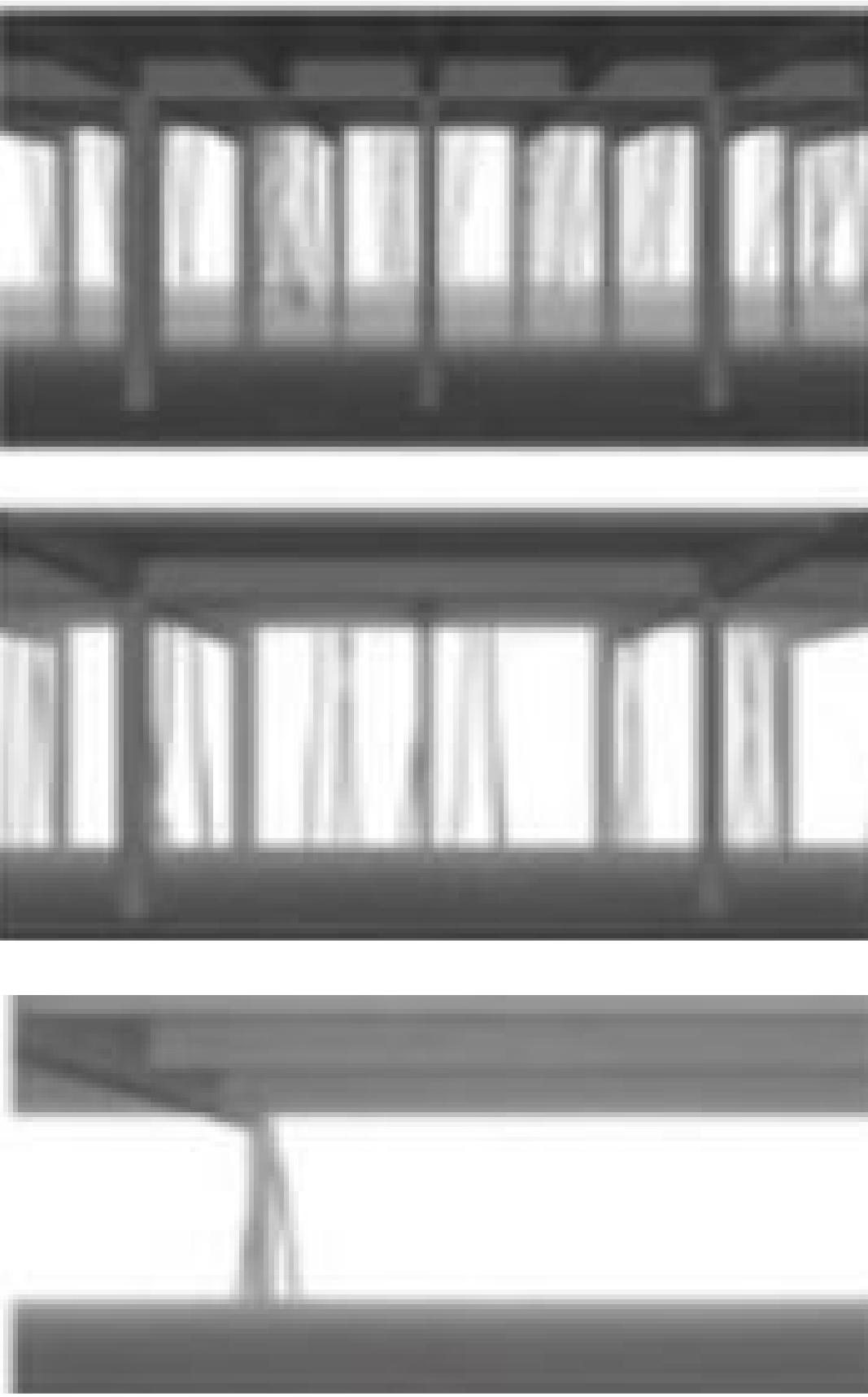
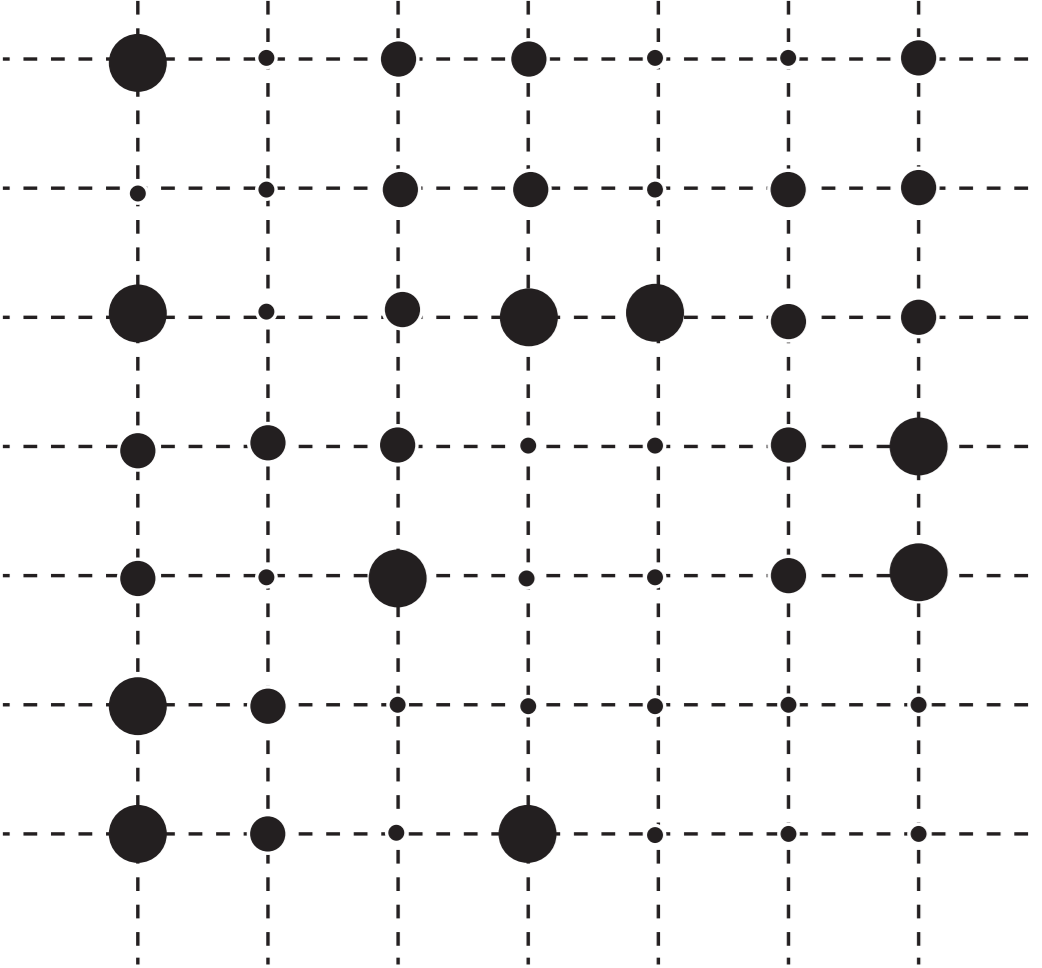

ARCHITECTURE, LAB CITY, REM KOOLHAAS

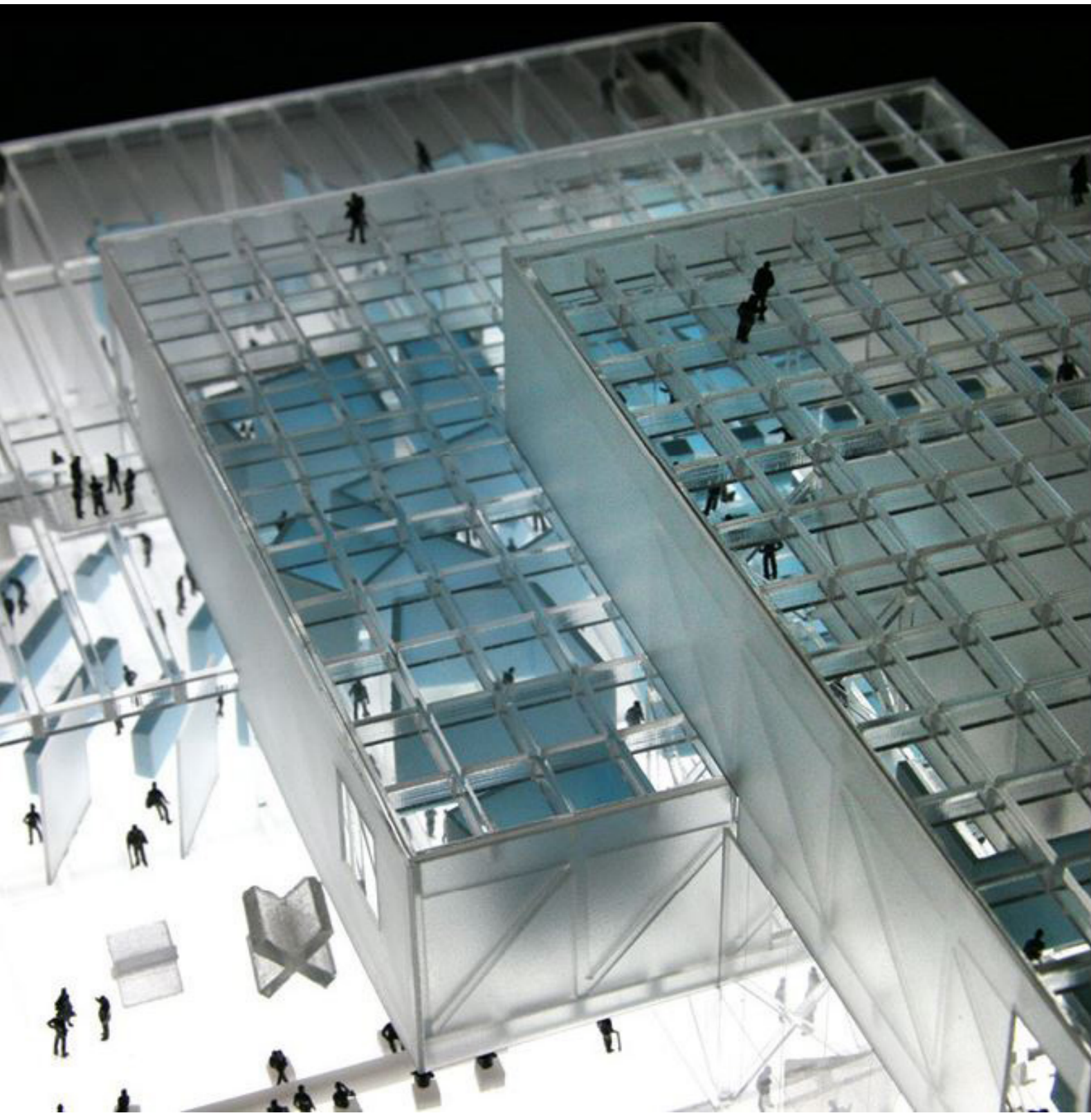
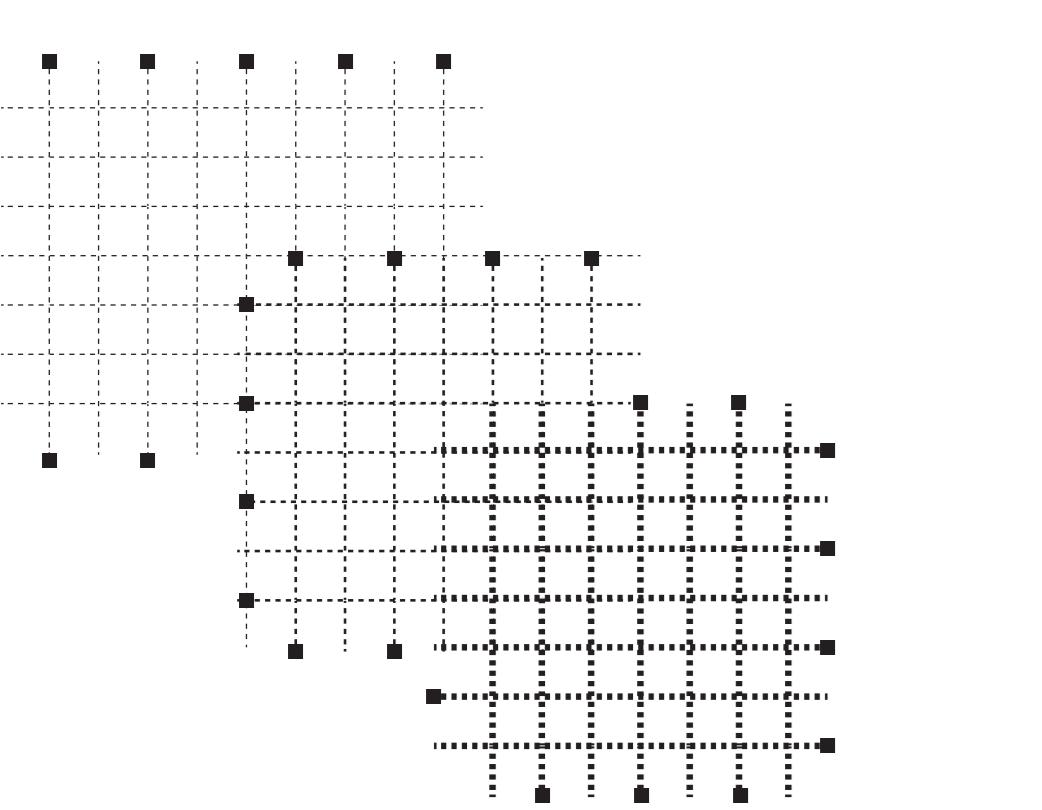

PAYSAGE, BERNARD TSCHUMI,
PARC LA VILLETTE

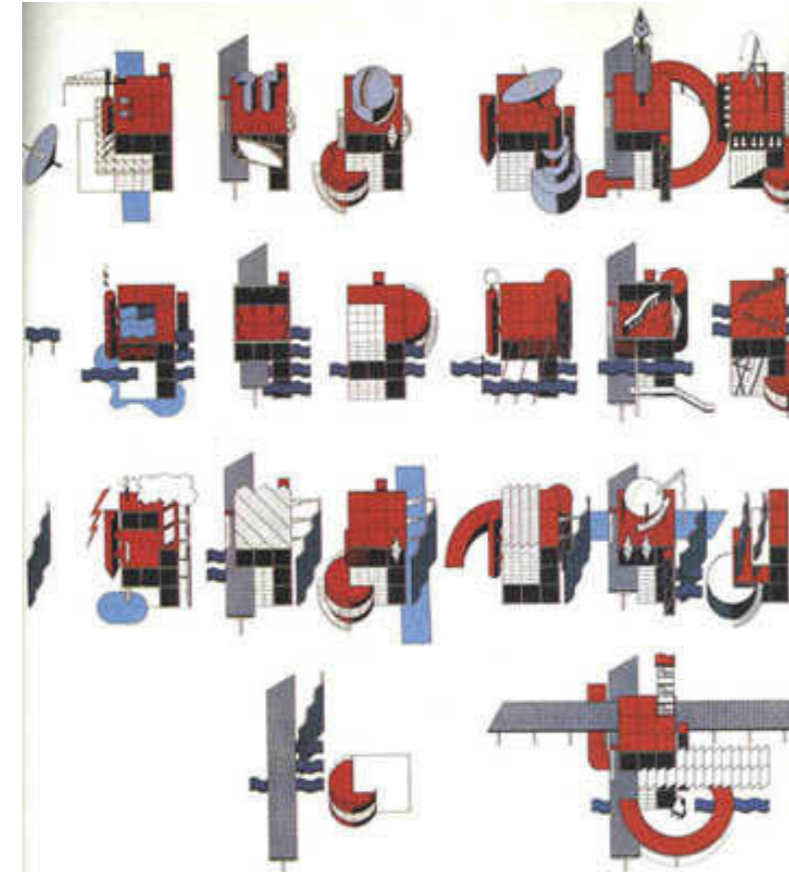
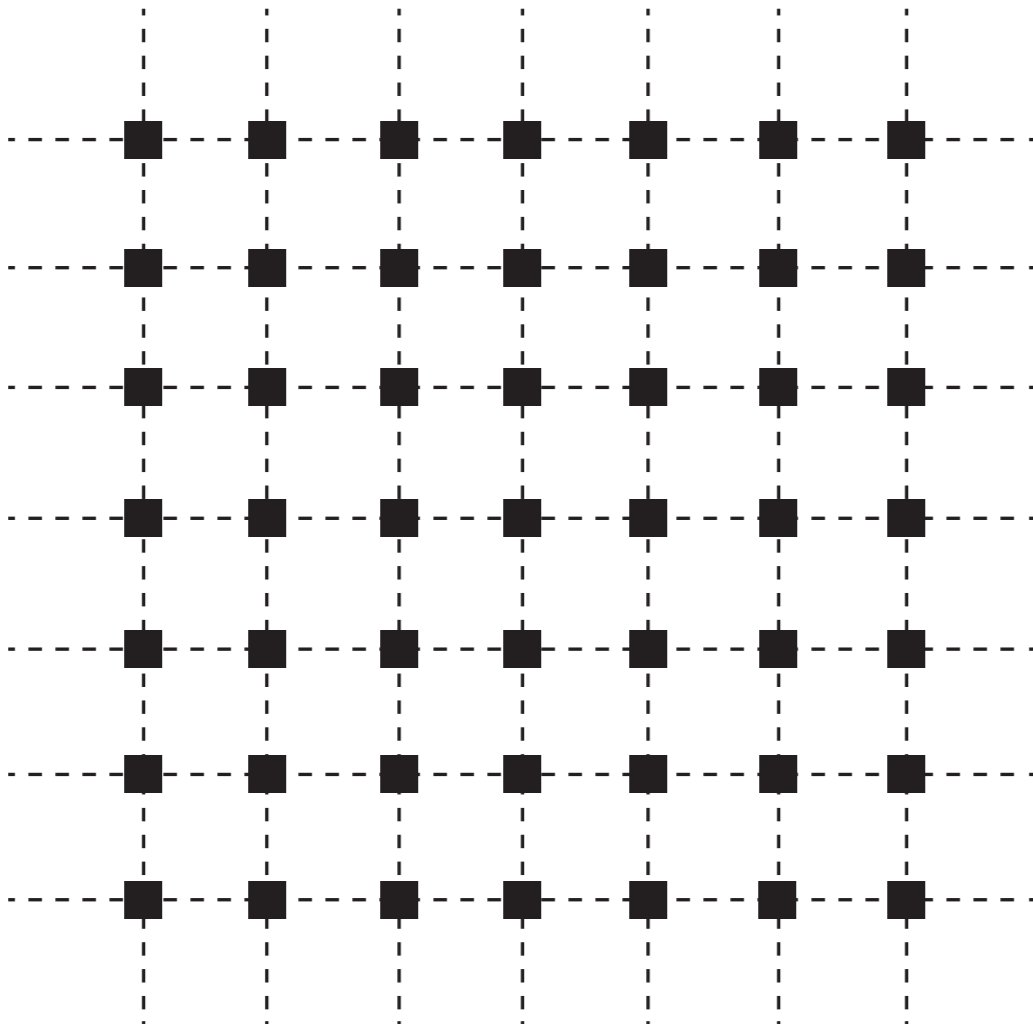

ARCHITECTURE, VRC MEDIA CENTER, CHRISTIAN KEREZ 2

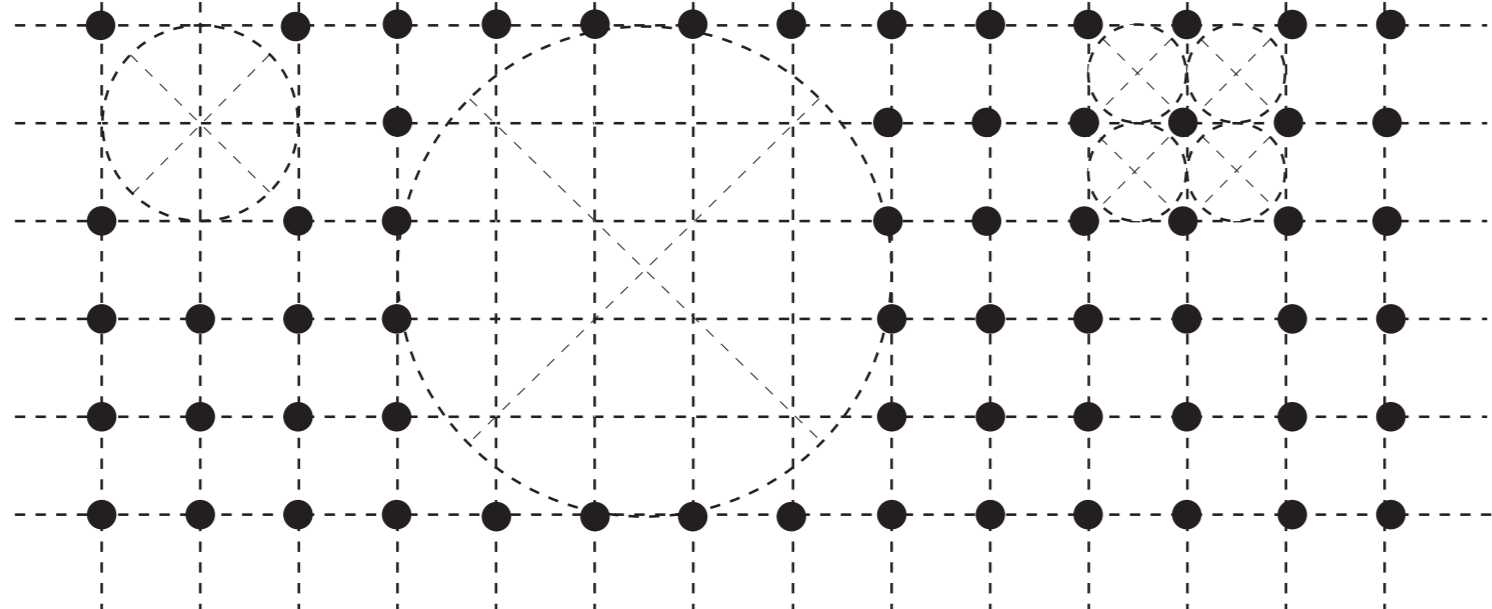

ARCHITECTURE, JUNYA ISHIGAMI,
KANAGAWA INSTITUTE OF TECHNOLOGY

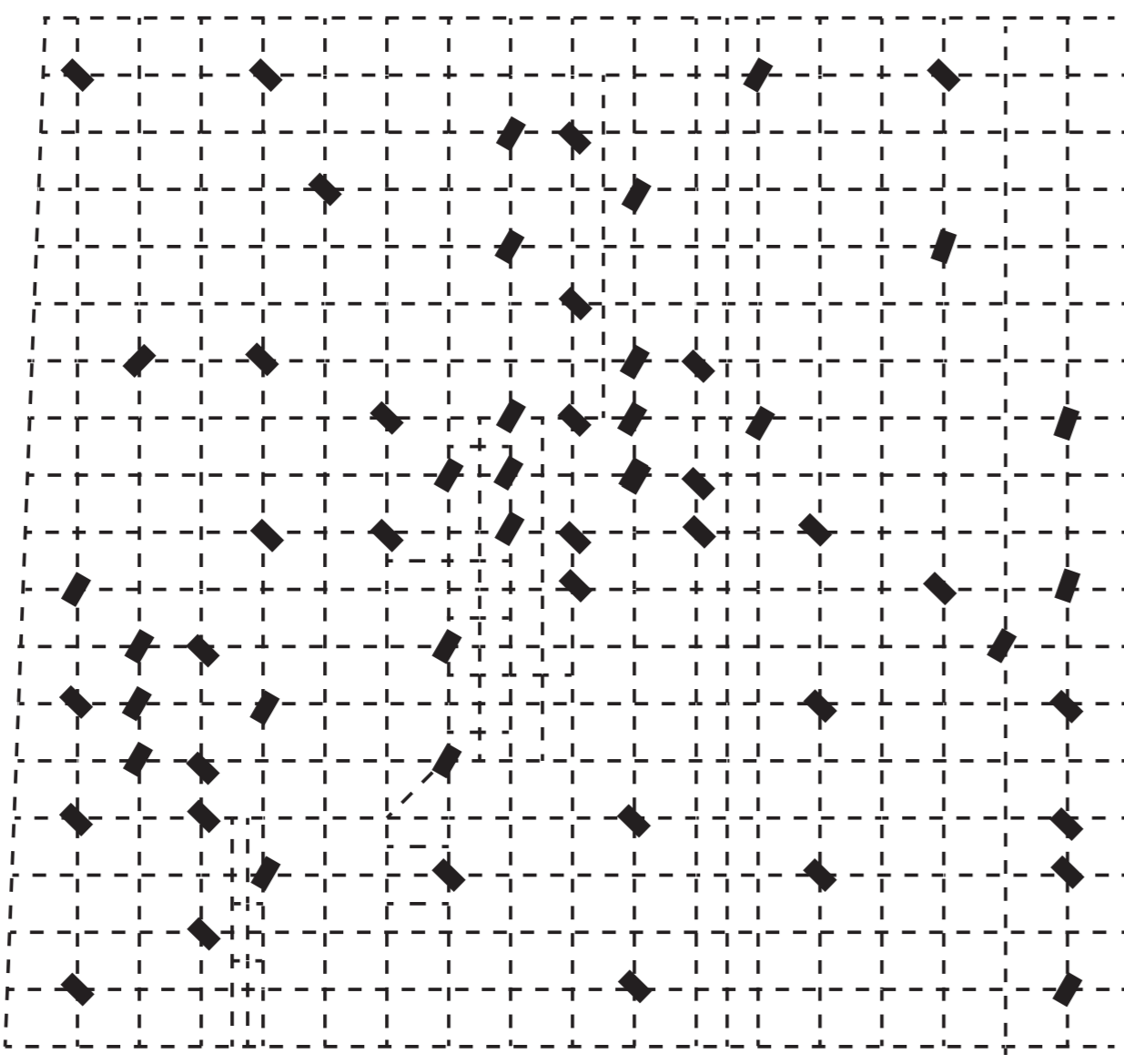

ARCHITECTURE, CONCEPT, CHRISTIAN KEREZ 3

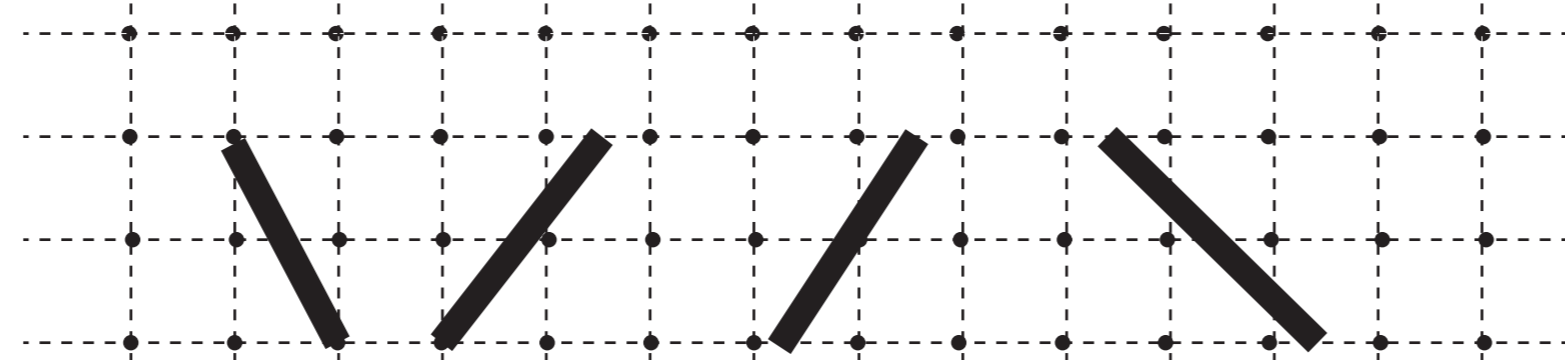

EXAMPLE R+1

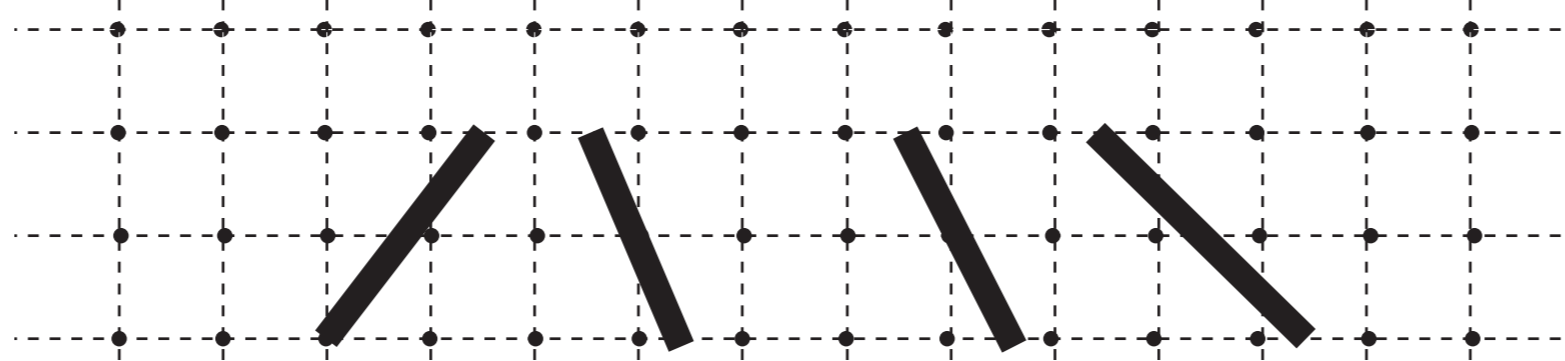

EXAMPLE R+2

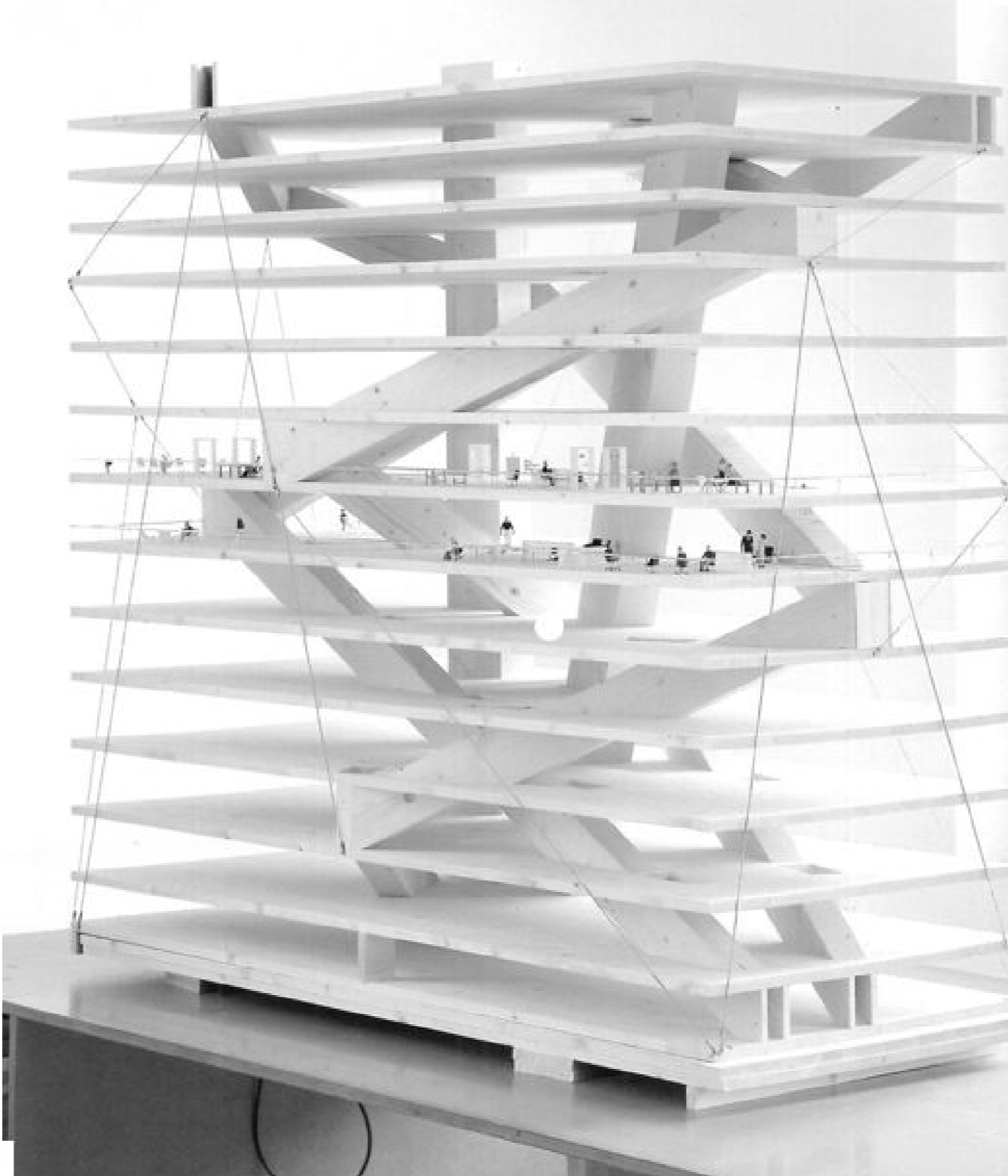

ARCHITECTURE, TAMA ART UNIVERSITY, TOYO ITO,

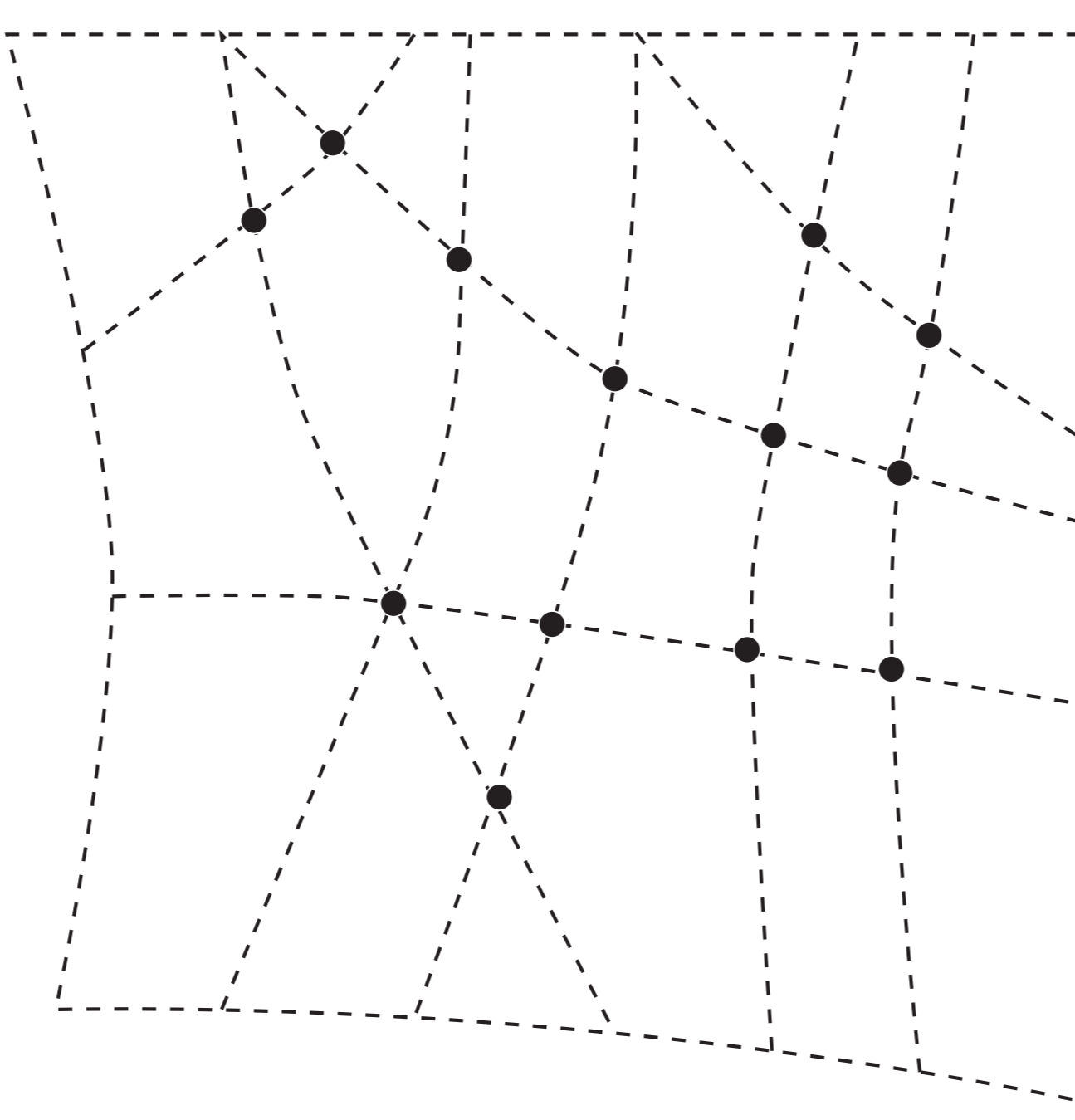

2 BIOGRAPHIE , LA GRILLE. QUELLE STRUCTURE?

ESPACE INTERIEUR, JUNYA ISHIGAMI,INSTITUTE OF TCHENOLOGY WORKSHOP KANAGAWA , IMPRESSION D'UNE FORET

ESPACE INTERIEUR

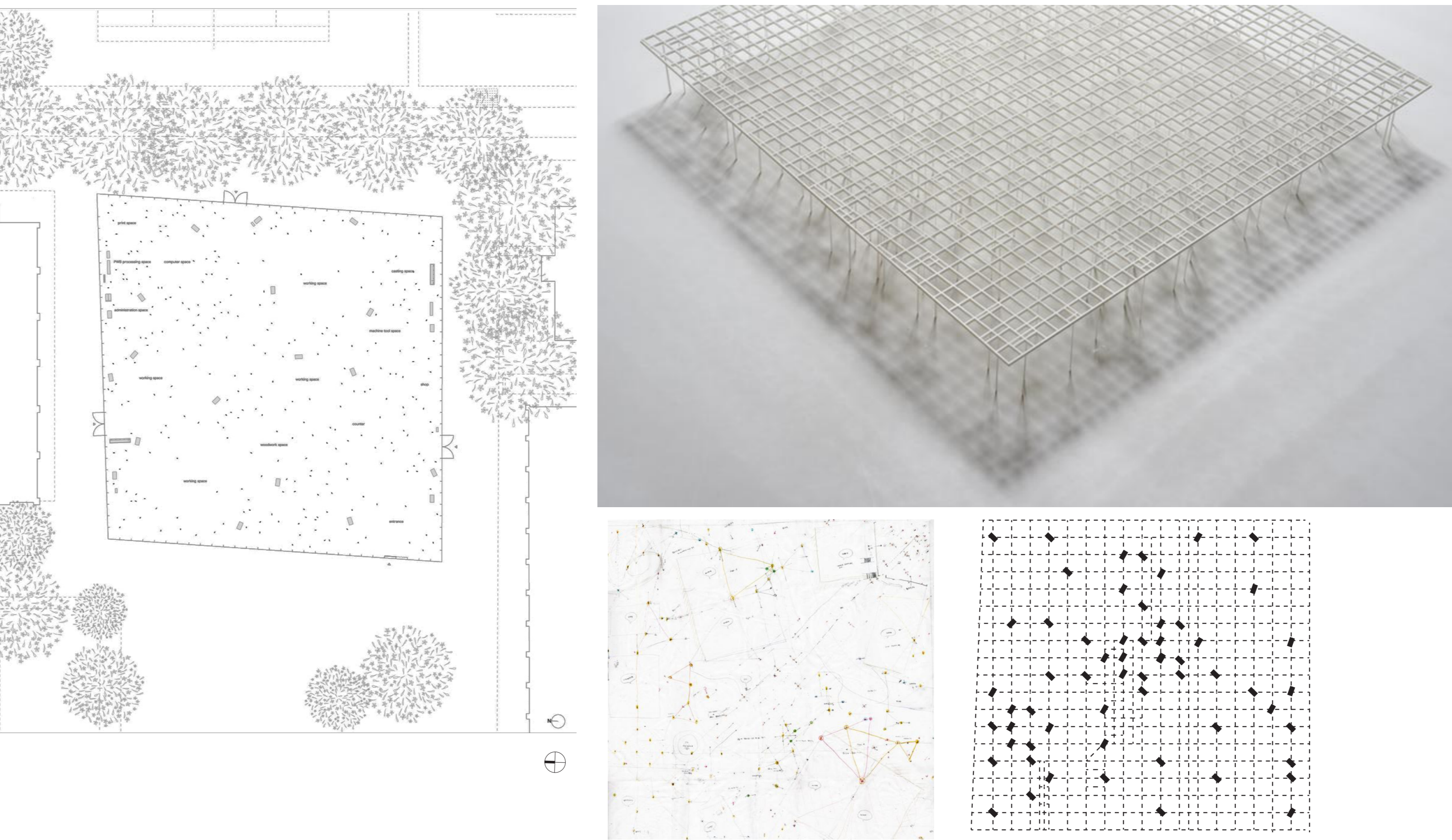

DETAL COUPE STRUCTURE METALLIQUE

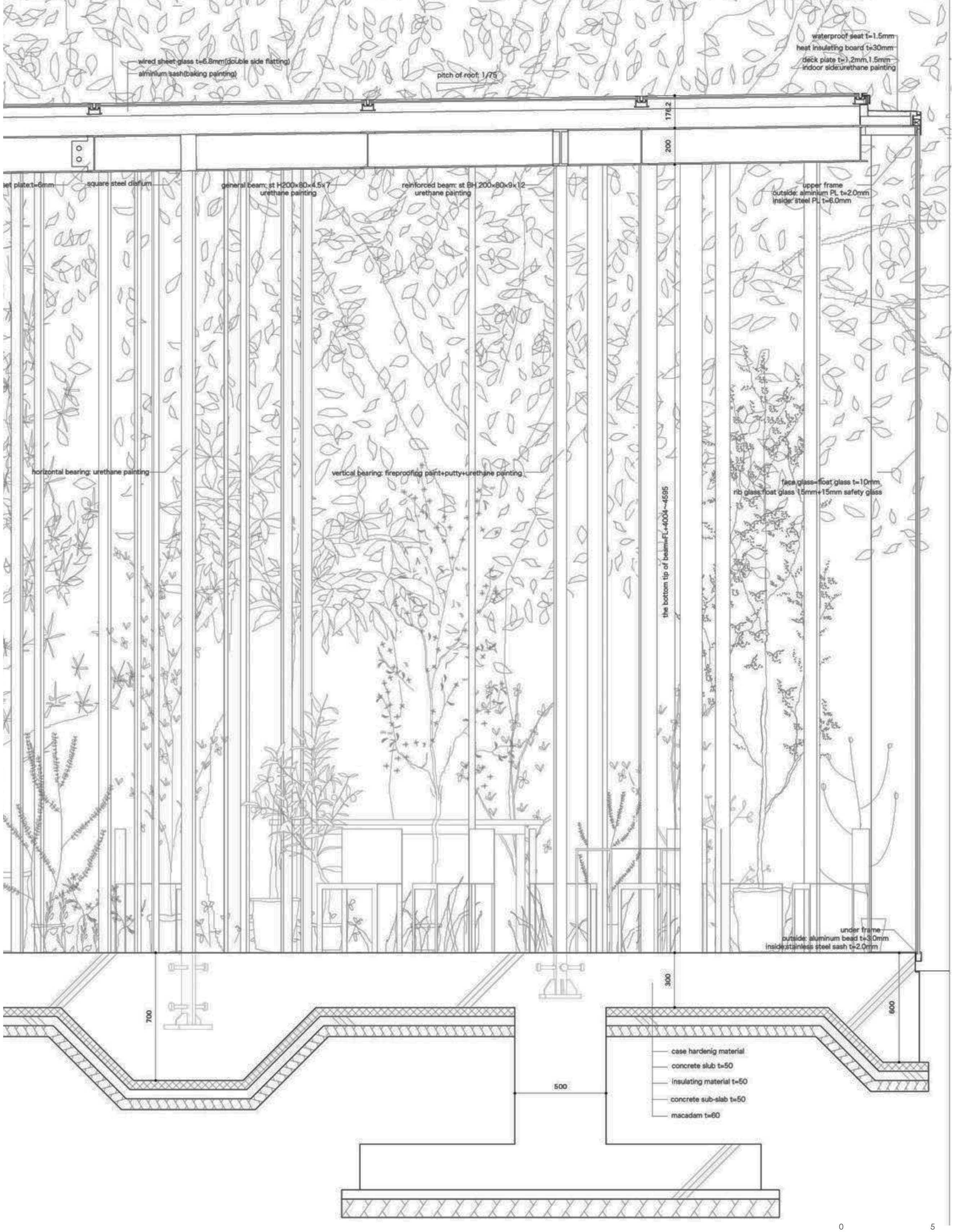

ENVELOPPE TOITURE, KENGO KUMA , HOTEL DE VILLE NAGAOKA, LA TOITURE FAIT APPARAÎTRE LA GRILLE + ENTREE

DETAL COUPE SUR LA STRUCTURE MIXTE LA TOITURE STRUCTURE METALLIQUE / FILTRAGE SOLS

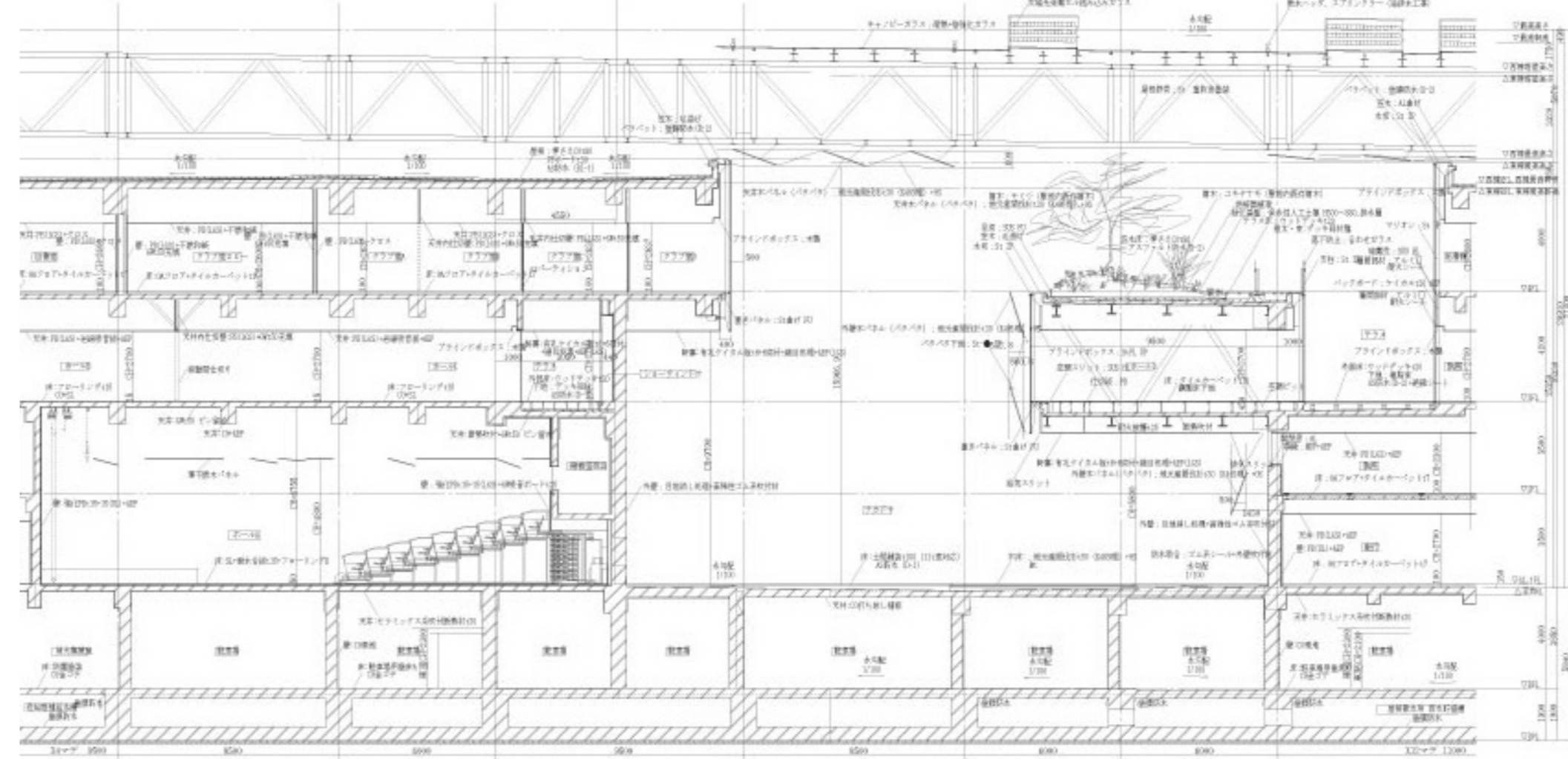

DETAL COUPE SUR LA STRUCTURE MIXTE PRINCIPALE DE FACADE POSSIBILITE DE LOGEMENT EN DOUBLE PEAU

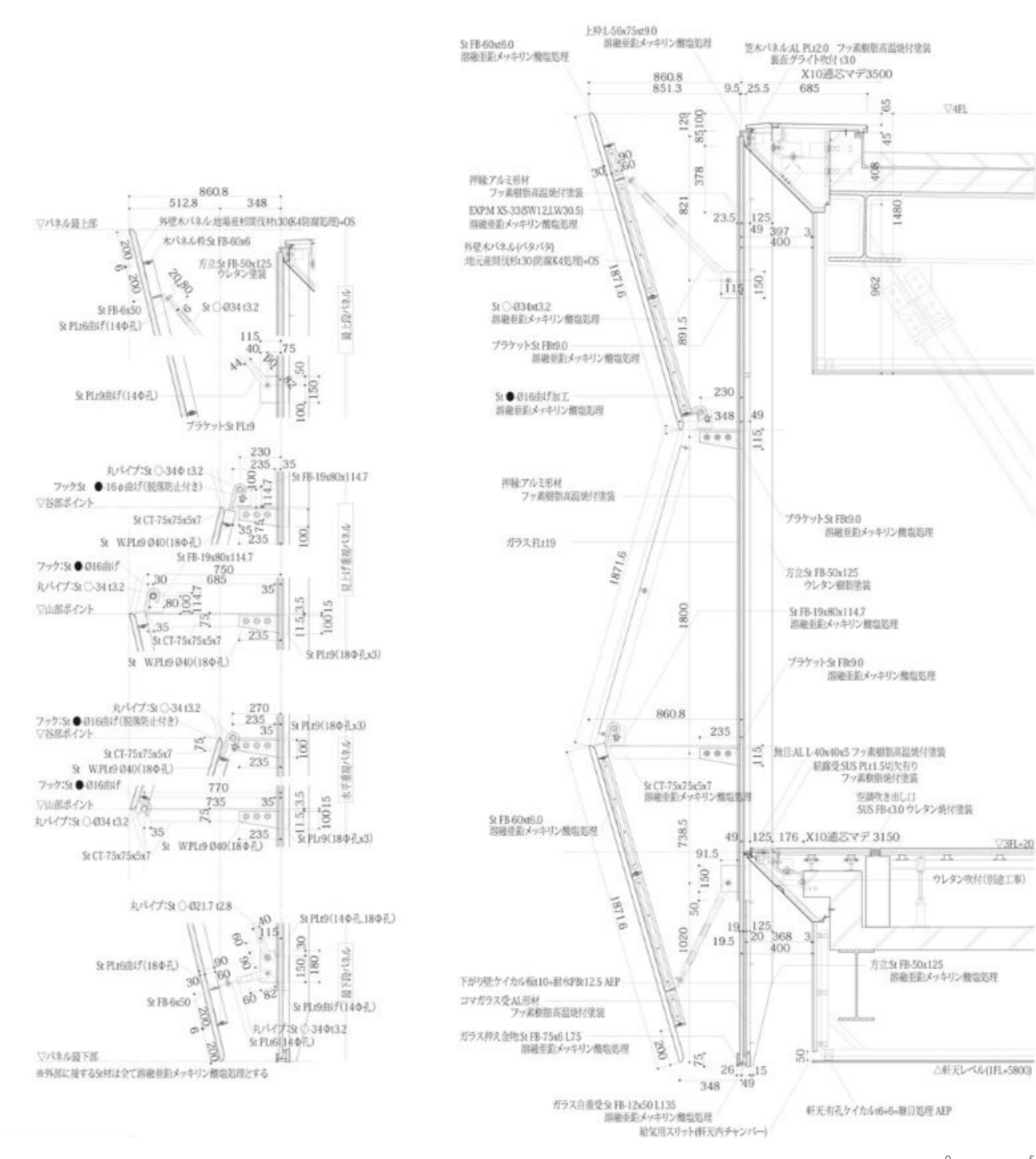

ESPACE INTERIEUR



CONTEXTE STRATEGIE D'IMPLANTATION DOUBLE CIRCULATION

