

2 BIOGRAPHIE UNIVERSITÉ ET CENTRE DE RECHERCHE D'ART ET DE MÉDECINE. QUEL PROGRAMME?

PROGRAMME DE MÉDECINE, GRAFTON ARCHITECTS, UNIVERSITY OF LIMERICK, IRELANDE.



PROGRAMME	PROGRAMME/METRE CARREE	R-1	R-2	R-3
1 Foyer		7 Self Directed learning 229m ²	12 Clinical Skills 2060/4m ² +161,18m ²	20 School Reception 9,86m ²
2 Café			13 Anatomical Skills 64,82m ² +57,57m ²	21 Research Laboratory 109,77m ² +34,41m ² +144,18m ²
3 Auditorium	RDC	8 Computer room 178,833m ²	14 Computer Lab 44m ²	22 Research write-up area 73,358m ²
4 Seminar room		9 Problem-based learning 148,106m ²	15 Clinical Skills Video 13,82m ²	23 Staff room 41,548m ²
5 Colonnade	Entrance	10 GP Score 37,49m ²	16 Self Directed Learning 43,20m ²	24 Kitchen 74,831m ²
6 Store/plant		11 Circulations 51,350m ² +144,149m ² (3 elevages) +75,052m ²	17 Hot Desks 17,202m ²	25 Meeting Room 14,828m ²
7 Self-directed learning		4 Salle de séminaire 88,11m ² 96,53m ² +184,64	18 Offices + Offices R+3 67,03m ²	26 Courtyard 31,17m ² + 8.518m ²
8 Computer room	1 Foyer	Non pris en compte	19 Store + Store R+3 39,686m ²	
9 Problem-based learning	241m ²			
10 GP Score	2 Café			
11 Circulation	74 m ² +35m ² =109m ²			
12 Clinical skills	3 Auditorium			
13 Anatomical Skills	179,08m ²			
14 Computer Lab	5 Colonnade/Espace extérieure			
15 Clinical Skills Video	307,85m ²			
16 Self Directed Learning				
17 Hot Desks	6 Rangement			
18 Offices	81,28m ² +28,90m ² =90,18m ²			
19 Store				
20 School Reception				
21 Research Laboratory				
22 Research write-up area				
23 Staff room				
24 Kitchen				
25 Meeting Room				
26 Courtyard				
METRE CARRÉ TOTALE				
5988,8684m ²				
METRE CARRÉ UTILE				
4422,4979m ²				



2 BIOGRAPHIE UNIVERSITÉ ET CENTRE DE RECHERCHE D'ART ET DE MÉDECINE. QUEL PROGRAMME?

COOP HIMMELBLAU, EXTENTION DE L'ACADEMIE D'ART DE VIENNE, AUTRICHE, ECOLE D'ART.

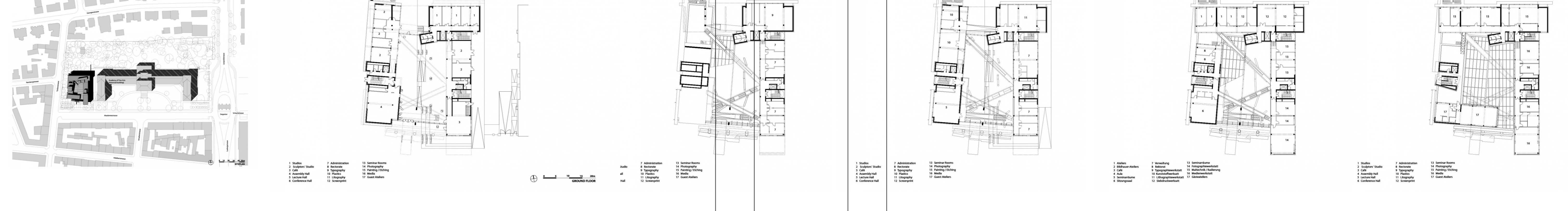

Programme	RDC	R-1	R-2	R-3
1 Studio	Ground Floor	7 Administration 47,46m ² +46,47m ² +52,104m ² = 42,098m ²	5 Lecture Hall 117,12m ²	1 Studio 27,59m ² +22,57m ² +23,15m ² +24,52m ² +24,55m ² = 122,28m ²
2 Atelier Sculpture	Entrance 622,075m ²	8 Administration 188,37m ²	10 Plastics 87,45m ² +51,01m ² =138,46m ²	6 Conference halls 90,56m ²
3 Café		9 Typography 168,076m ²	11 Litography 36,62m ² +22,79m ² +114,80m ² =162,52m ²	12 Screenprint 27,41m ² +37,89m ² =75,30m ²
4 Assembly Hall		10 Plastics 87,45m ² +51,01m ² =138,46m ²	13 Seminar Rooms 27,41m ² +37,89m ² =65,30m ²	14 Photography 36,62m ² +22,79m ² =59,41m ²
5 Lecture Hall		11 Litography 36,62m ² +22,79m ² +114,80m ² =162,52m ²	15 Painting/Etching 52,27m ² +47,81m ² +157,28m ² =257,36m ²	16 Media 245,799m ²
6 Conference Hall		12 Screenprint 27,41m ² +37,89m ² =65,30m ²	17 Guest Ateliers 170,880m ²	
7 Administration		13 Seminar Rooms 27,41m ² +37,89m ² =65,30m ²		
8 Rectorate		14 Photography 36,62m ² +22,79m ² =59,41m ²		
9 Typography		15 Painting/Etching 52,27m ² +47,81m ² +157,28m ² =257,36m ²		
10 Plastics		16 Media 245,799m ²		
11 Litography		17 Guest Ateliers 170,880m ²		
12 Screenprint				
13 Seminar Rooms				
14 Photography				
15 Painting/Etching				
16 Media				
17 Guest Ateliers				
METRE CARRÉ BRUT	9 900m ²			
METRE CARRÉ UTILE	= 3379,712m ² /5668m ²			

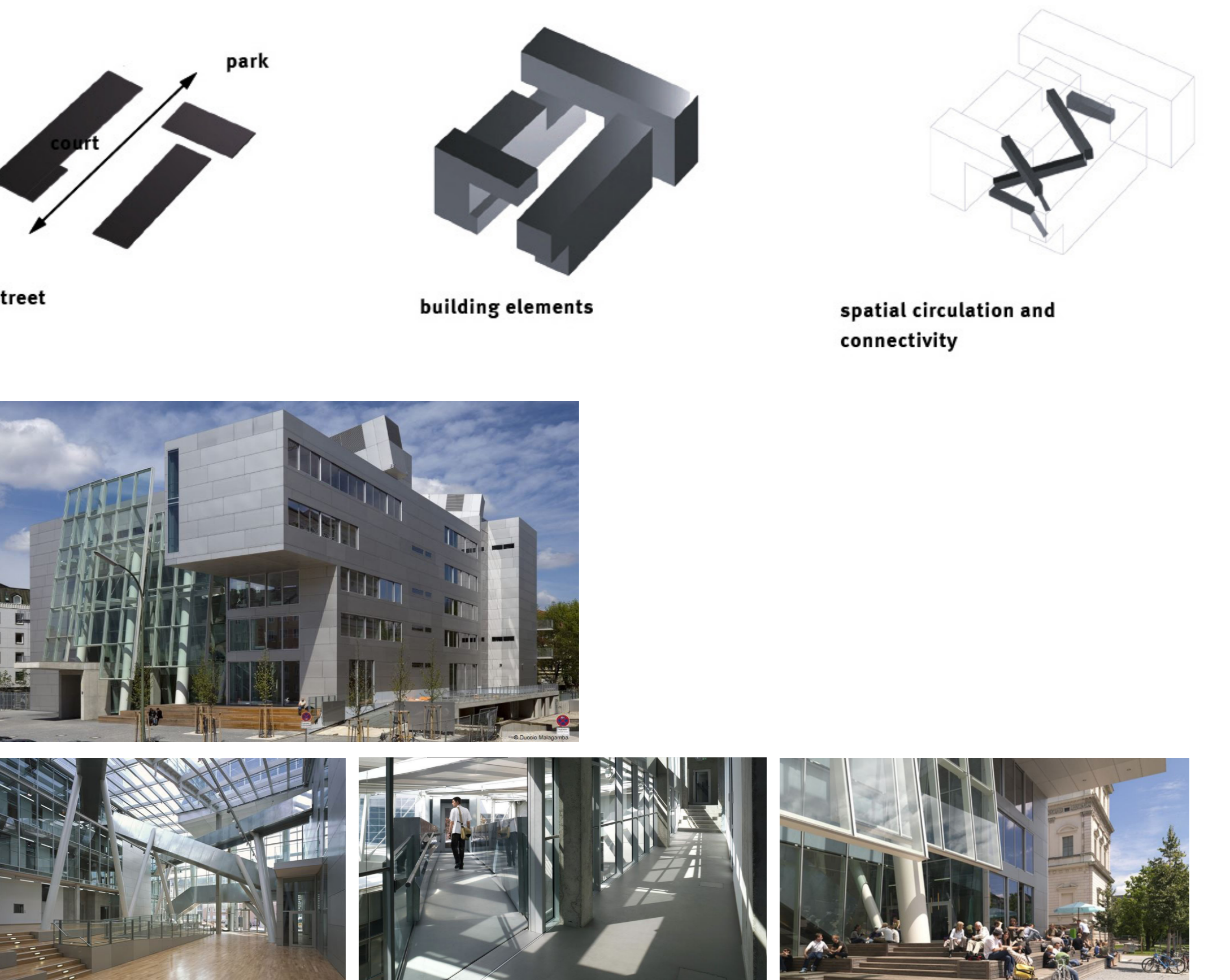
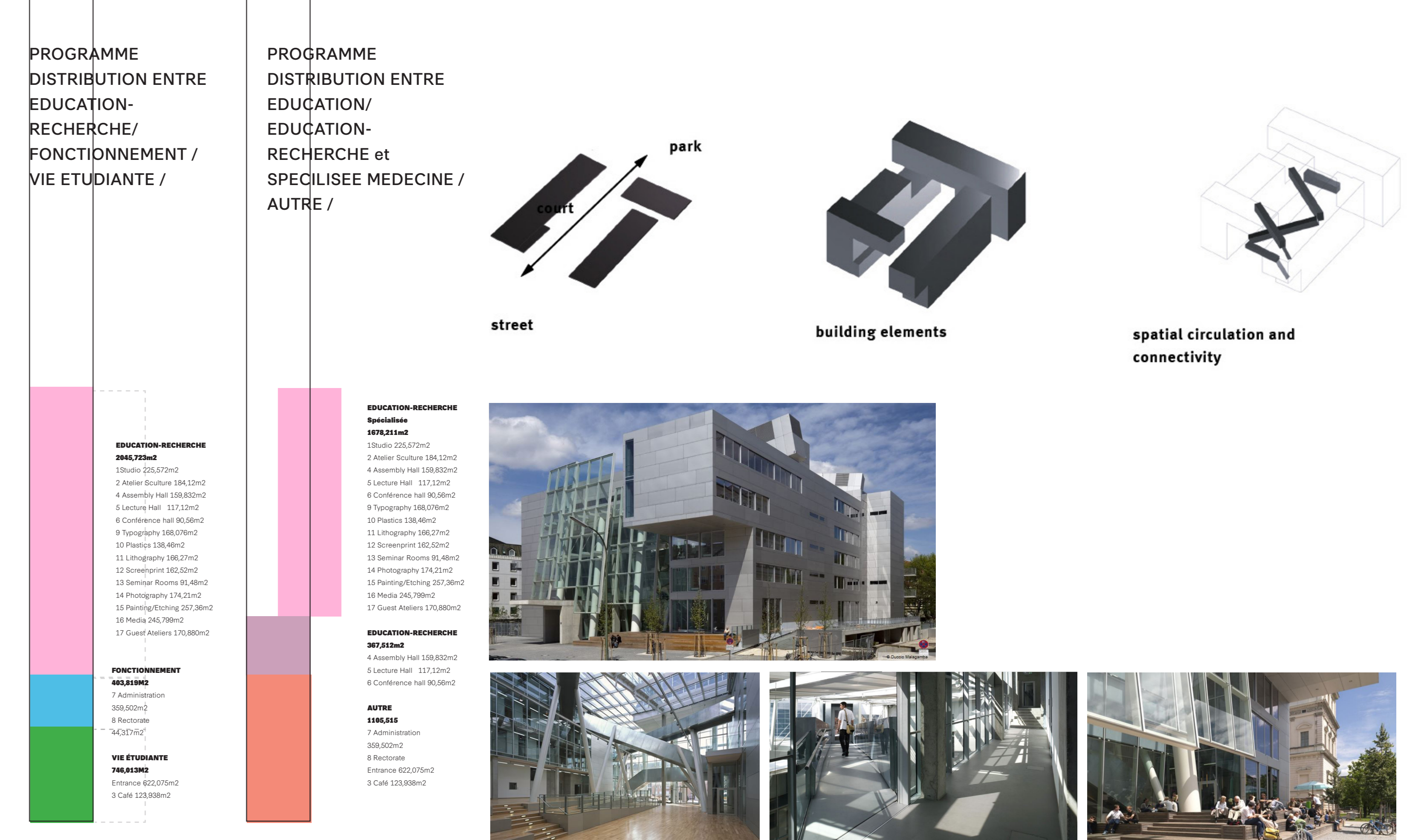

PROGRAMME DE MEDICINE, DILLER SCOFIDO+RENFROROY ET DIANA VAGELOS EDUCATION CENTER À COLUMBIA UNIVERSITY MEDICAL, USA

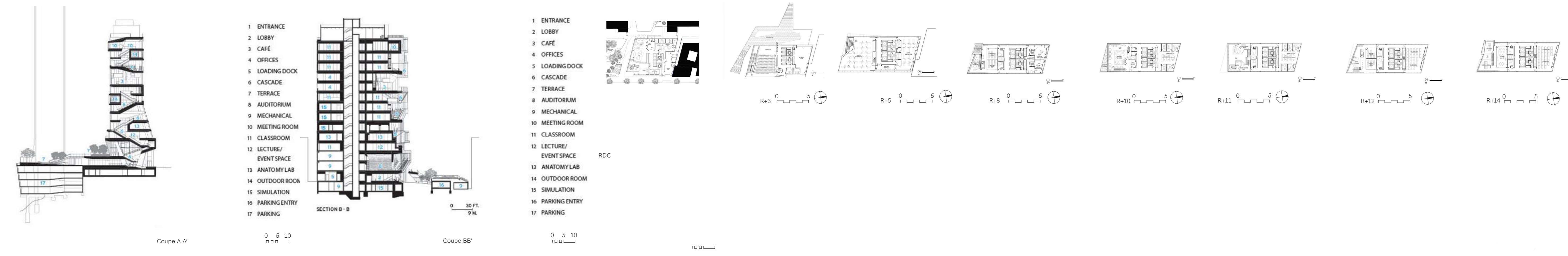

PROGRAMME	PROGRAMME/METRE CARREE	R-1	R-2	R-3
1 Entrance		1 9 Mechanical 1451(3)=404,40m ²	10 Meeting Room 30m ² +30m ² =90m ²	2
2 Lobby	561,98 F2		11 Classroom 9778F2=908,49m ²	9
3 Café	52,20704m ²		1 Classroom simulation 8335 F2= 774,3468m ²	1
4 Offices			12 Lecture/event space 8663F2=897,7221	1
5 Loading Dock	2 Lobby		13 Anatomy Lab 2151,31F2=197,92m ²	2
6 Cascade	1458,27 F2		14 Out door room 157,40F2+157,40F2	2
7 Terrace	135,28746m ²		5 314,8F2=28,39m ² Compris dans cascade	15 Simulation 8663F2=897,7221
8 Auditorium			16 Parking Entry XX	1
9 Mechanical	3 Café		17 Parking XX	1
10 Meeting room	1672,02 F2			
11 Classroom	155,33 m ²			
12 Lecture/Event Space	4 offices			
13 Anatomy Lab	3104F2			
14 Outdoor Room	288, 371m ²			
15 Simulation				
16 Parking Entry				
17 Parking				
METRE CARRÉ TOTALE				
10,000m ²				
METRE CARRÉ UTILE				
XXm ²				

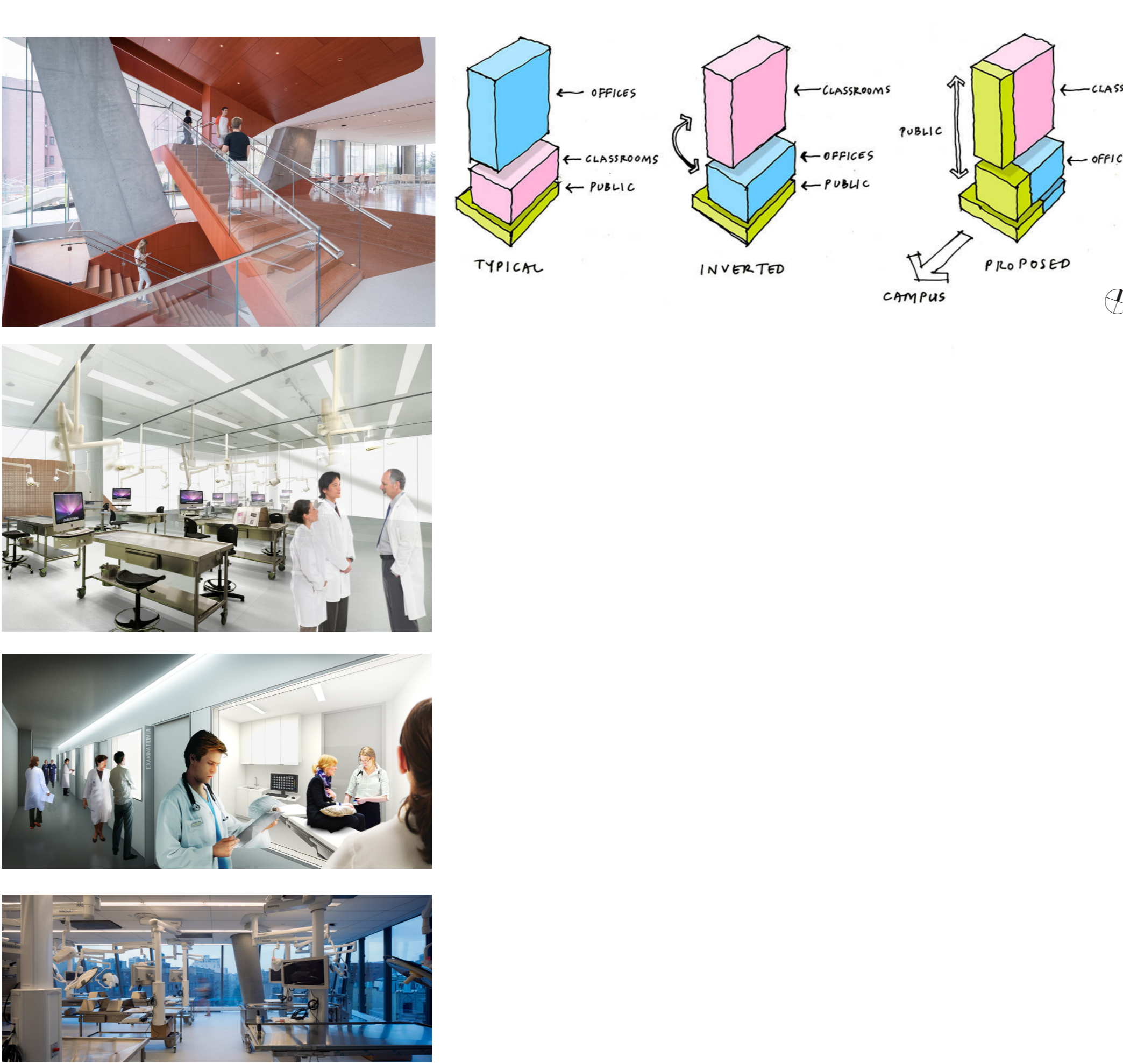
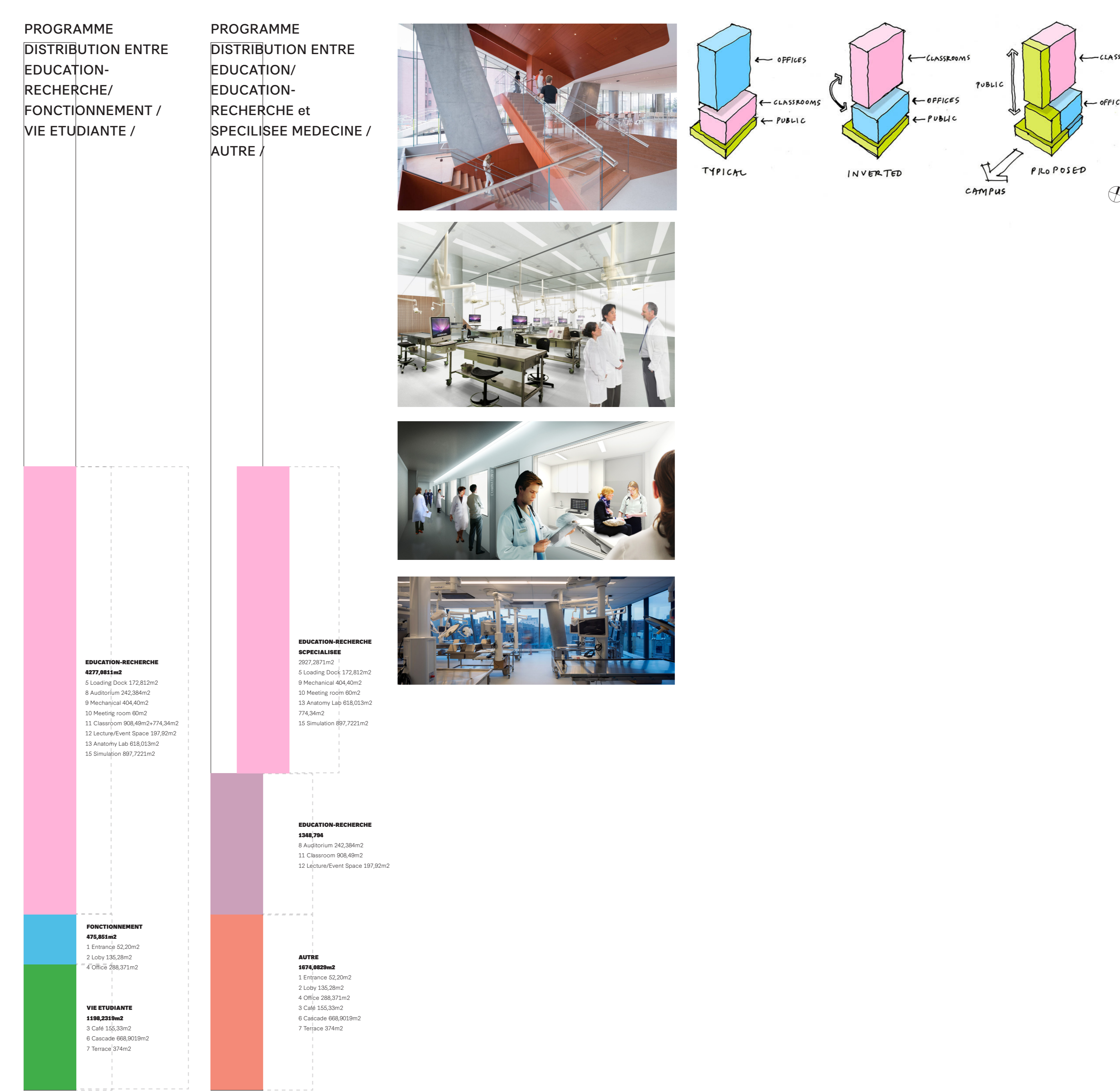

CONSTRUCTION DU PROGRAMME MIXTE A PARTIR DES 3 PROGRAMMES.

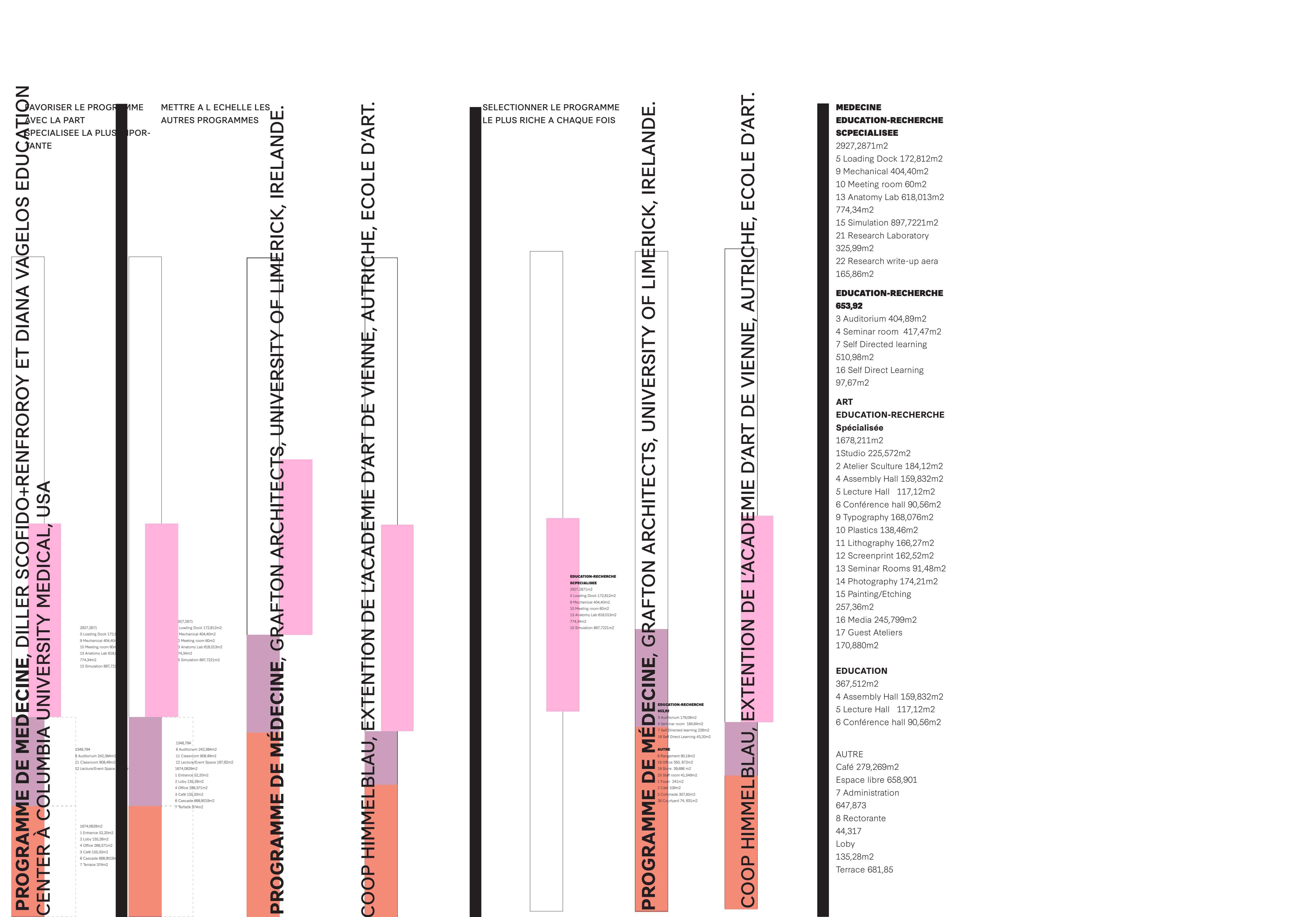

PROGRAMME DE MEDICINE, DILLER SCOFIDO+RENFROROY ET DIANA VAGELOS EDUCATION CENTER À COLUMBIA UNIVERSITY MEDICAL, USA

PROGRAMME DE MEDICINE, GRAFTON ARCHITECTS, UNIVERSITY OF LIMERICK, IRELANDE.

COOP HIMMELBLAU, EXTENTION DE L'ACADEMIE D'ART DE VIENNE, AUTRICHE, ECOLE D'ART.

PROGRAMME DE MEDICINE, GRAFTON ARCHITECTS, UNIVERSITY OF LIMERICK, IRELANDE.

COOP HIMMELBLAU, EXTENTION DE L'ACADEMIE D'ART DE VIENNE, AUTRICHE, ECOLE D'ART.

PROGRAMME DE MEDICINE, GRAFTON ARCHITECTS, UNIVERSITY OF LIMERICK, IRELANDE.

COOP HIMMELBLAU, EXTENTION DE L'ACADEMIE D'ART DE VIENNE, AUTRICHE, ECOLE D'ART.

PROGRAMME DE MEDICINE, GRAFTON ARCHITECTS, UNIVERSITY OF LIMERICK, IRELANDE.

COOP HIMMELBLAU, EXTENTION DE L'ACADEMIE D'ART DE VIENNE, AUTRICHE, ECOLE D'ART.

PROGRAMME DE MEDICINE, GRAFTON ARCHITECTS, UNIVERSITY OF LIMERICK, IRELANDE.

COOP HIMMELBLAU, EXTENTION DE L'ACADEMIE D'ART DE VIENNE, AUTRICHE, ECOLE D'ART.

PROGRAMME DE MEDICINE, GRAFTON ARCHITECTS, UNIVERSITY OF LIMERICK, IRELANDE.

COOP HIMMELBLAU, EXTENTION DE L'ACADEMIE D'ART DE VIENNE, AUTRICHE, ECOLE D'ART.

PROGRAMME DE MEDICINE, GRAFTON ARCHITECTS, UNIVERSITY OF LIMERICK, IRELANDE.

COOP HIMMELBLAU, EXTENTION DE L'ACADEMIE D'ART DE VIENNE, AUTRICHE, ECOLE D'ART.

PROGRAMME DE MEDICINE, GRAFTON ARCHITECTS, UNIVERSITY OF LIMERICK, IRELANDE.

COOP HIMMELBLAU, EXTENTION DE L'ACADEMIE D'ART DE VIENNE, AUTRICHE, ECOLE D'ART.

PROGRAMME DE MEDICINE, GRAFTON ARCHITECTS, UNIVERSITY OF LIMERICK, IRELANDE.

COOP HIMMELBLAU, EXTENTION DE L'ACADEMIE D'ART DE VIENNE, AUTRICHE, ECOLE D'ART.

PROGRAMME DE MEDICINE, GRAFTON ARCHITECTS, UNIVERSITY OF LIMERICK, IRELANDE.

COOP HIMMELBLAU, EXTENTION DE L'ACADEMIE D'ART DE VIENNE, AUTRICHE, ECOLE D'ART.

PROGRAMME	PROGRAMME/METRE CARREE
MEDICINE-RECHERCHE SCPECIALISEE	2927,2873m ²
5 Loading Dock	172,812m ²
9 Mechanical	404,40m ²
10 Meeting room	60m ²
13 Anatomy Lab	618,013m ²
14 Out door room	314,8m ²
15 Simulation	897,7221m ²
21 Research Laboratory	325,99m ²
22 Research write-up area	165,88m ²
EDUCATION-RECHERCHE	653,82
3 Auditorium	404,88m ²
4 Seminar room	417,47m ²
7 Self Directed learning	510,8m ²
16 Self Direct Learning	97,67m ²
ART	
EDUCATION-RECHERCHE Specialisee	1678,211m ²
1 Studio	225,572m ²
2 Atelier Sculpture	184,12m ²
4 Assembly Hall	159,832m ²
5 Lecture Hall	117,12m ²
6 Conference hall	90,56m ²
9 Typography	168,076m ²
10 Plastics	138,46m ²
11 Litography	162,52m ²
12 Screenprint	162,52m ²
13 Seminar Rooms	91,48m ²
14 Photography	174,21m ²
15 Painting/Etching	257,36m ²
16 Media	245,799m ²
17 Guest Ateliers	170,880m ²
EDUCATION	
567,512m ²	
4 Assembly Hall	159,832m ²
5 Lecture Hall	117,12m ²
6 Conference hall	90,56m ²
AUTRE	
Café	279,269m ²
Espace libre	658,901
7 Administration	847,873
8 Rectorate	44,317
Lobby	135,28m ²
Terrace	681,85